

# VESTING TENTATIVE MAP

## CABRILLO-DOLORES FACULTY HOUSING

### STANFORD SANTA CLARA COUNTY CALIFORNIA

LEGEND		
	PROPOSED	EXISTING
BOUNDARY LINE/ SUBDIVISION BOUNDARY	---	---
EASEMENT	---	---
CENTERLINE	---	---
SETBACK LINE	---	---
CONTOUR LINE	105	105
CONCRETE CURB AND GUTTER	SD LINE	12" SD
STORM DRAIN MAIN	SS	8" SS
SANITARY SEWER MAIN	W	8" W
WATER MAIN	---	---
FENCE	x x x x	OH
OVERHEAD POWER	---	---
CATCH BASIN/DROP INLET	■	□
AREA DRAIN	●	○
MANHOLE	●	○
CLEANOUT	●	○
WATER METER	○	WM
FIRE HYDRANT	●	○
WATER VALVE	✂	✂
LUMINAIRE	×	×
SPOT ELEVATION	209.9	x101
PARKING STALL NUMBER	20	
TRANSFORMER	▲	

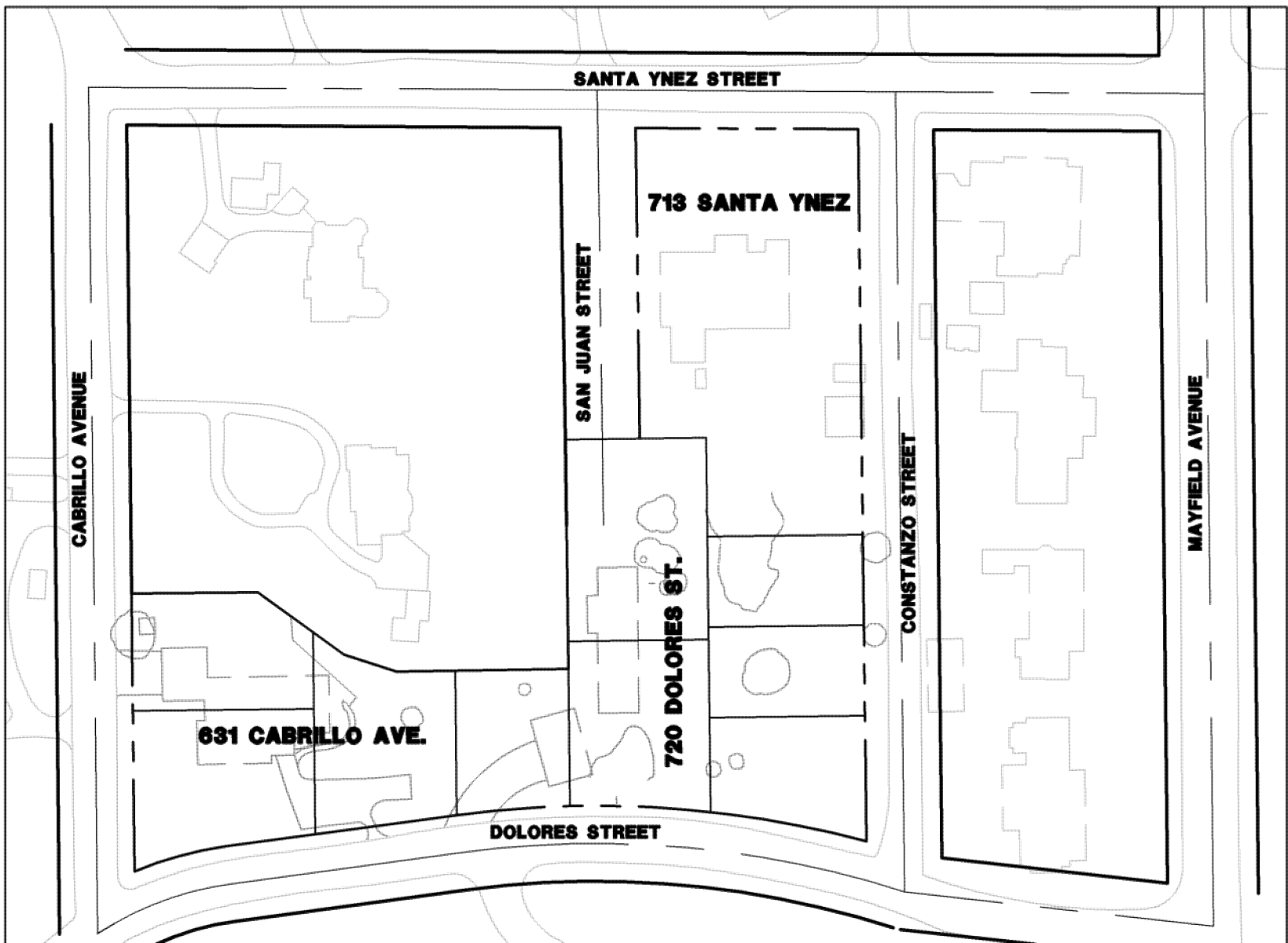

**SITE MAP**  
1"=100'

#### SHEET INDEX

TM 1.1	TITLE SHEET
TM 2.1	LAND USE AND ZONING MAP
TM 2.2	LOT LAYOUT PLAN
TM 3.1-3.4	EXISTING CONDITIONS
TM 4.1-4.4	DEMOLITION AND TREE DISPOSITION PLAN
TM 5.1-5.4	SITE PLAN
TM 6.1-6.4	GRADING AND DRAINAGE PLAN
TM 7.1-7.4	UTILITY PLAN
TM 8.1	CIVIL DETAILS
TM 9.1-9.4	SECTIONS

#### STATEMENT OF INTENT

THIS SUBDIVISION SHOWN ON THIS TENTATIVE MAP IS A RESUBDIVISION OF THE LANDS OF THE BOARD OF TRUSTEES OF THE LELAND STANFORD JUNIOR UNIVERSITY, A BODY HAVING CORPORATE POWERS UNDER THE LAWS OF THE STATE OF CALIFORNIA. SAID SUBDIVISION IS LOCATED WITHIN THE COUNTY OF SANTA CLARA, STATE OF CALIFORNIA, AND HAVING ASSESSOR'S PARCEL NUMBERS 142-08-022, 142-08-023 AND 142-08-024.

LELAND STANFORD JUNIOR UNIVERSITY

DATE

#### SURVEYOR'S STATEMENT

THIS TENTATIVE MAP HAS BEEN PREPARED BY ME OR UNDER MY DIRECTION IN ACCORDANCE WITH THE STATE OF CALIFORNIA SUBDIVISION MAP ACT.

DAVIS THRESH, L.S.  
ASSOCIATE/PROJECT MANAGER  
BKF ENGINEERS

DATE



#### ENGINEER'S STATEMENT

THIS TENTATIVE MAP HAS BEEN PREPARED BY ME OR UNDER MY DIRECTION IN ACCORDANCE WITH STANDARD ENGINEERING PRACTICE.

MITCHEL W. BURLEY, P.E.  
PROJECT MANAGER  
BKF ENGINEERS

DATE



#### GENERAL NOTES

- VESTING TENTATIVE MAP:** THIS VESTING TENTATIVE MAP IS BEING FILED IN ACCORDANCE WITH CHAPTER 3, ARTICLE 2, SECTION 66452 OF THE SUBDIVISION MAP ACT.
- VESTING TENTATIVE MAP:** THIS VESTING TENTATIVE MAP CONFORMS TO THE REQUIREMENTS OF SECTION C12-20 "FORM AND CONTENT OF TENTATIVE MAPS" OF THE COUNTY OF SANTA CLARA MUNICIPAL CODE.
- TOPOGRAPHY:** TOPOGRAPHY IS BASED ON THE FIELD SURVEY PREPARED BY BKF ENGINEERS IN OCTOBER 2016.
- BENCHMARK:** TOP OF 2" DIAMETER BRASS DISK WITH PUNCH MARK, STAMPED "STANFORD 19 LS 5237", IN MONUMENT WELL IN THE AC WALK ON THE EAST SIDE OF MAYFIELD AVENUE 350'+ NORTH OF CAMPUS DRIVE EAST.  
ELEVATION = 109.17 FEET (NGVD29), AND 112.11 (NAVD88)
- BOUNDARY:** BOUNDARY AND EASEMENTS SHOWN IS BASED ON RECORD INFORMATION AS PROVIDED IN THE PRELIMINARY (TITLE) REPORT ISSUED BY \_\_\_\_\_ ORDER NO. \_\_\_\_\_ AND DATED \_\_\_\_\_, 20\_\_\_\_.
- UTILITIES:** UTILITY SIZING AND LOCATIONS ARE PRELIMINARY AND SUBJECT TO FINAL ENGINEERING DESIGN.
- EASEMENT DEDICATIONS:** THERE WILL BE PRIVATE ON-SITE STORM DRAIN EASEMENTS.

#### OWNER/SUBDIVIDER:

LELAND STANFORD JR UNIVERSITY  
3160 PORTER DR., #200  
PALO ALTO, CA 94304  
TEL: (650) 724-4990  
ATTN.: GRACE STEPHENS

#### ENGINEER:

BKF ENGINEERS  
1730 NORTH FIRST STREET, SUITE 600  
SAN JOSE, CALIFORNIA 95112

#### AREA:

ACREAGE - 2.00 AC

#### ASSESSORS PARCEL NO.:

142-08-022, 023 AND 024

#### ZONE DISTRICT:

R1S: LOW DENSITY CAMPUS RESIDENTIAL AND A1: GENERAL USE

#### EXISTING USE:

SINGLE FAMILY RESIDENTIAL DETACHED

#### PROPOSED USE:

SINGLE FAMILY RESIDENTIAL DETACHED

#### PROPOSED IMPROVEMENTS:

DEMOLISH TWO (2) EXISTING RESIDENCES AND SITE IMPROVEMENTS AND RESUBDIVIDE THREE (3) EXISTING PARCELS INTO TEN (10) NEW LOTS AND CONSTRUCTION EIGHT (8) NEW RESIDENTIAL UNITS, CONSTRUCT STREET INFRASTRUCTURE AND PROVIDE UTILITY SERVICES, INCLUDING STORM, SANITARY, WATER, GAS, ELECTRIC AND TELEPHONE.

#### ABBREVIATIONS

SYMBOL	DESCRIPTION	SYMBOL	DESCRIPTION
AB	AGGREGATE BASE	MAX	MAXIMUM
AC	ASPHALT CONCRETE	MIN	MINIMUM
AD	AREA DRAIN	MOUNT	MOUNTABLE
ALT	ALTERNATIVE	NO	NUMBER
AVE	AVENUE	NTS	NOT TO SCALE
BB	BOTTOM OF BANK	OH	OVERHEAD
BLDG	BUILDING	PAE	PUBLIC ACCESS EASEMENT
BOW	BACK OF WALK	PCC	POINT OF COMPOUND CURVE or PORTLAND CEMENT CONCRETE
BOX	BOX	PG&E	PACIFIC GAS & ELECTRIC PROPERTY LINE
CB	CATCH BASIN	PR	PROPOSED
C&G	CURB & GUTTER	PSDE	PRIVATE STORM DRAIN EASEMENT
C	CENTERLINE	PSSE	PRIVATE SANITARY SEWER EASEMENT
CL	CLASS	PUE	PUBLIC UTILITY EASEMENT
CO	CLEANOUT	PVC	POLYVINYL CHLORIDE
CONC	CONCRETE	PYE	PRIVATE YARD EASEMENT
CPA	CITY OF PALO ALTO STANDARD DETAILS	R	RIGHT, RADIUS
CR	CURB RETURN	RCP	REINFORCED CONCRETE PIPE
CU	COPPER UTILITY LINE	RPV	REDUCED PRESSURE VALVE
D/W	DRIVEWAY	ROW	RIGHT OF WAY
DDCV	DOUBLE DETECTOR CHECK VALVE	R/W	RETAINING WALL
DWG	DRAWING	SD	STORM DRAIN
EL	ELEVATION	SDMH	STORM DRAIN MANHOLE
EG	EXISTING GRADE	SS	SANITARY SEWER
EP	EDGE OF PAVEMENT	SSE	PRIVATE SANITARY SEWER EASEMENT
EVAE	EMERGENCY VEHICLE ACCESS EASEMENT	SSMH	SANITARY SEWER MANHOLE
EX	EXISTING	SW S/W	SIDEWALK
FC	FACE OF CURB	TB	TOP OF BANK
FT	FINISHED FLOOR ELEVATION	TC	TOP OF CURB
FG	FINISHED GRADE	TO	TOP OF GRADE
FH	FIRE HYDRANT	TP	TOP OF PAVEMENT
FL	FLOW LINE	T/R	TITLE REPORT
FS	FIRE SERVICE	TRANS	TRANSFORMER
FT	FEET	TYP	TYPICAL
FW	FIRE WATER	VERT	VERTICAL
G	GAS LINE	W	WATER
GB	GRADE BREAK	W/	WITH
OFF	GARAGE FINISHED FLOOR	WM	WATER METER
HC	HANDICAPPED ACCESSIBLE	WV	WATER VALVE
HDS	HYDRODYNAMIC SEPARATOR		
HORZ	HORIZONTAL		
HP	HIGH POINT		
INV	INVERT		
JB	JUNCTION BOX		
L	LEFT, LENGTH		
LP	LOW POINT		
L/S	LANDSCAPE		

CABRILLO DOLORES FACULTY HOUSING  
VESTING TENTATIVE MAP  
TITLE SHEET

CALIFORNIA

SANTA CLARA COUNTY

STANFORD

No.	Revisions
08/30/17	Design MMB
08/30/17	Drawn
08/30/17	Approved
08/30/17	Job No 20166131

Drawing Number:  
**TM1.1**  
**1** OF **28**

**BKF100**  
YEARS  
ENGINEERS . SURVEYORS . PLANNERS  
1730 NORTH FIRST ST.,  
SUITE 600  
SAN JOSE, CA 95112  
(408) 487-9100  
www.bkf.com