

**NOTES**

- EXISTING TREES SHOWN ARE ON SIGNIFICANT BUILDING SITES WHERE SURVEYS HAVE BEEN CONDUCTED.
- NUMBER OF HABITAT ENCLOSURES IN PRESENT CONTRACT:

SPECIES	# ENCL.
SONGBIRDS	8
SQUIRRELS	7
SEABIRD WATERFOWL, SHOREBIRD & PELAGIC BIRDS	7
DOVE & BAND-TAILED PIGEONS	3
OPOSSUMS	1
RACCOON	2
RAPTORS	4
FOX	1
SKUNK	1
BOBCAT & COYOTE	3
RABBITS	2
JAYS, CROWS & RAVENS	6
TURKEY	1
QUAIL	1
DEER	2
(OVERFLOW/FLEXIBLE SPECIES)	1
<b>TOTAL</b>	<b>50</b>

**FIRE DEPT. NOTES**

- ACCESS ROADS TO A POINT JUST NORTH OF THE ENDANGERED SPECIES FACILITY ARE TO BE 20' IN WIDTH
- EXISTING ROAD FROM NORTH OF THE ENDANGERED SPECIES FACILITY TO TOP OF SITE TO BE PAVED WITH A.C. PAVING (OR SIMILAR ALL WEATHER SURFACE) TO MINIMIZE EROSION. THIS ROAD WILL VARY IN WIDTH FROM 12' TO 15' DEPENDING ON TERRAIN WITH PULLOUT AREAS.
- SEE CIVIL DRAWINGS FOR UTILITIES IN ROADWAY
- ROADWAY INSIDE TURNING RADIUS MAX. 50'-0"
- ACCESS ROADS AND DRIVEWAYS PAVED TO SUPPORT 40,000 LB. LOAD
- ROADWAY STRUCTURES TO SUPPORT 65,000 LB. WATER TENDER.
- ROAD GRADES FROM 15% TO 17% SHALL BE 4" PCC CONCRETE ROUGH SURFACED ON 4" AGGREGATE BASE
- TURNAROUNDS TO HAVE HAMMERHEAD "T" NO LESS THAN 60' IN LENGTH.
- ACCESS ROADS SHALL HAVE MAXIMUM SLOPE OF 17% PER CFMO-A1; IV-B.
- GATES SHALL BE MINIMUM 2' WIDER THAN TRAFFIC LANES
- MINIMUM OVERHEAD CLEARANCE = 15'
- FIRE HYDRANTS REQUIRED PRESSURE = 1500 GPM FOR 30 MINUTES

**LEGEND**

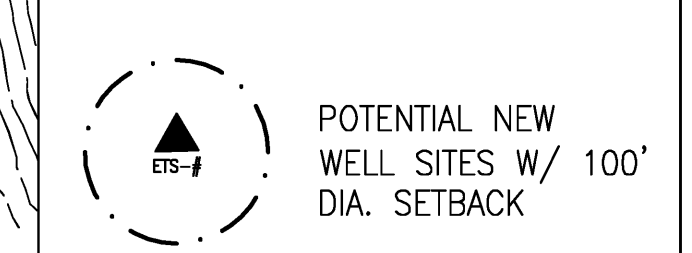

**USE PERMIT RESUBMITTAL**

**CONSERVATION CENTER FOR WILDLIFE CARE**

24103 CONGRESS SPRINGS ROAD  
SARATOGA, CA  
APN: 503-44-019

Issue

Rev	Date	By	Description
12/20/12			USE PERMIT SUBMITTAL
1	8/30/13		USE PERMIT RESUBMITTAL

Drawn By: GM  
Checked By: GM  
Job No.: 1026  
Issue Date: 08/13/13  
Scale: 1/128" = 1'-0"  
Reference North  
Drawing Title

**PROPOSED MASTER PLAN**

**A-S2**

Sheet  
These plans, drawings and specifications are the property of Swatt Miers Architects and any use and/or reuse thereof in part or in whole without the written permission of the Architect is prohibited. Copyright 2012 Swatt Miers Architects

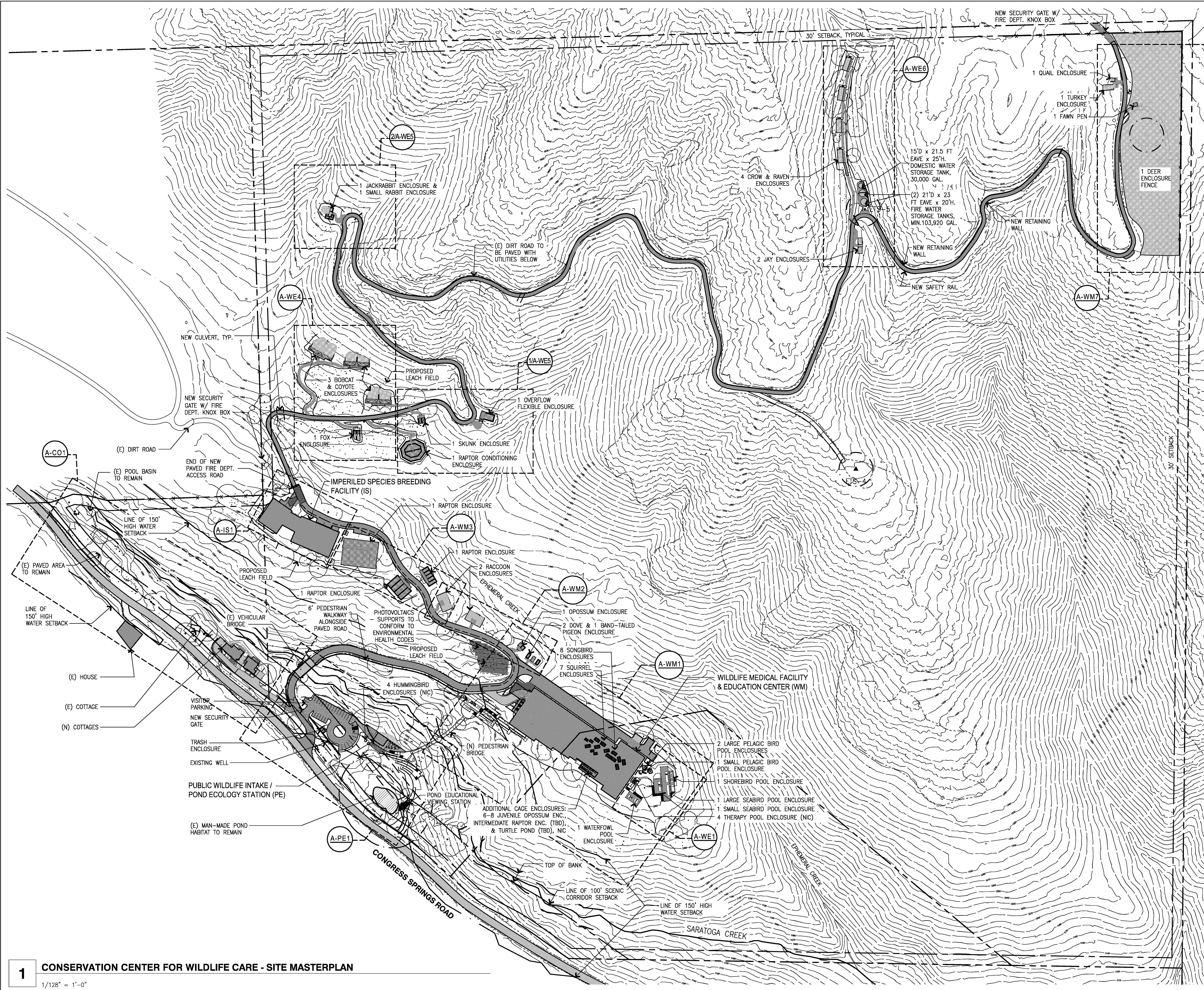

**1 CONSERVATION CENTER FOR WILDLIFE CARE - SITE MASTERPLAN**  
1/128" = 1'-0"