

**ORDINANCE NO. NS-1200.385**

**AN ORDINANCE OF THE BOARD OF SUPERVISORS OF THE COUNTY OF SANTA CLARA AMENDING THE OFFICIAL ZONING MAPS PURSUANT TO SECTION 1.20.060 OF APPENDIX I, ZONING, OF THE COUNTY OF SANTA CLARA ORDINANCE CODE TO INCLUDE THE -os HOUSING OPPORTUNITY SITES COMBINING DISTRICT**

Summary

This ordinance amends Appendix I, Zoning, of the County of Santa Clara Ordinance Code, to apply the -os Housing Opportunity Sites Combining District designation to the Official Zoning Maps.

**THE BOARD OF SUPERVISORS OF THE COUNTY OF SANTA CLARA, STATE OF CALIFORNIA, ORDAINS AS FOLLOWS:**

SECTION 1. The parcels included within the Housing Opportunity Sites Combining District boundaries listed on Exhibit 1: List of Parcels by APN, and depicted on Exhibit 2: Maps of Parcels, both of which are attached hereto and incorporated herein to apply the "-os" designator and the official zoning maps maintained pursuant to Section 1.20.060 of Chapter 1.20, Article 1, of Appendix I, Zoning, of the County of Santa Clara Ordinance Code, are hereby amended to reflect this rezoning.

**PASSED AND ADOPTED** by the Board of Supervisors of the County of Santa Clara, State of California, on \_\_\_\_\_ by the following vote:

AYES:  
NOES:  
ABSENT:  
ABSTAIN:

\_\_\_\_\_  
SUSAN ELLENBERG, President  
Board of Supervisors

Signed and certified that a copy of this document has been delivered by electronic or other means to the President, Board of Supervisors.

**ATTEST:**

\_\_\_\_\_  
TIFFANY LENNEAR  
Clerk of the Board of Supervisors

**APPROVED AS TO FORM AND LEGALITY:**

Lizanne Reynolds 9-19-23  
LIZANNE REYNOLDS  
Deputy County Counsel

Exhibits to this Ordinance:

- 1 – List of Parcels by APN
- 2 – Maps of Parcels

**Exhibit 1: List of Parcels**

APN	Current Zoning	Proposed Zoning
282-03-016	R1-8	R1-os
282-02-037	CN	CN-os
649-23-001	A	A-os
649-24-013	A	A-os
245-01-003	A	A-os
245-01-004	A	A-os
277-06-025	R1-n2	R1-os
277-12-029	CG	CG-os
277-12-027	CG	CG-os
277-07-028	CG	CG-os
277-07-027	CG	CG-os
277-07-029	CG	CG-os
277-08-029	CG	CG-os
277-08-030	CG	CG-os
277-08-031	CG	CG-os
601-25-119	R1	R1-os
601-07-066	R1	R1-os
612-21-004	R1-6	R1-os
599-39-047	CN	CN-os
599-01-064	CG	CG-os
419-12-044	CN	CN-os
142-04-036 (a)	A1-20s	A1-os
142-04-036 (b)	A1-20s	A1-os
142-04-036 (c)	A1-20s	A1-os

**Exhibit 2: Maps of Parcels**

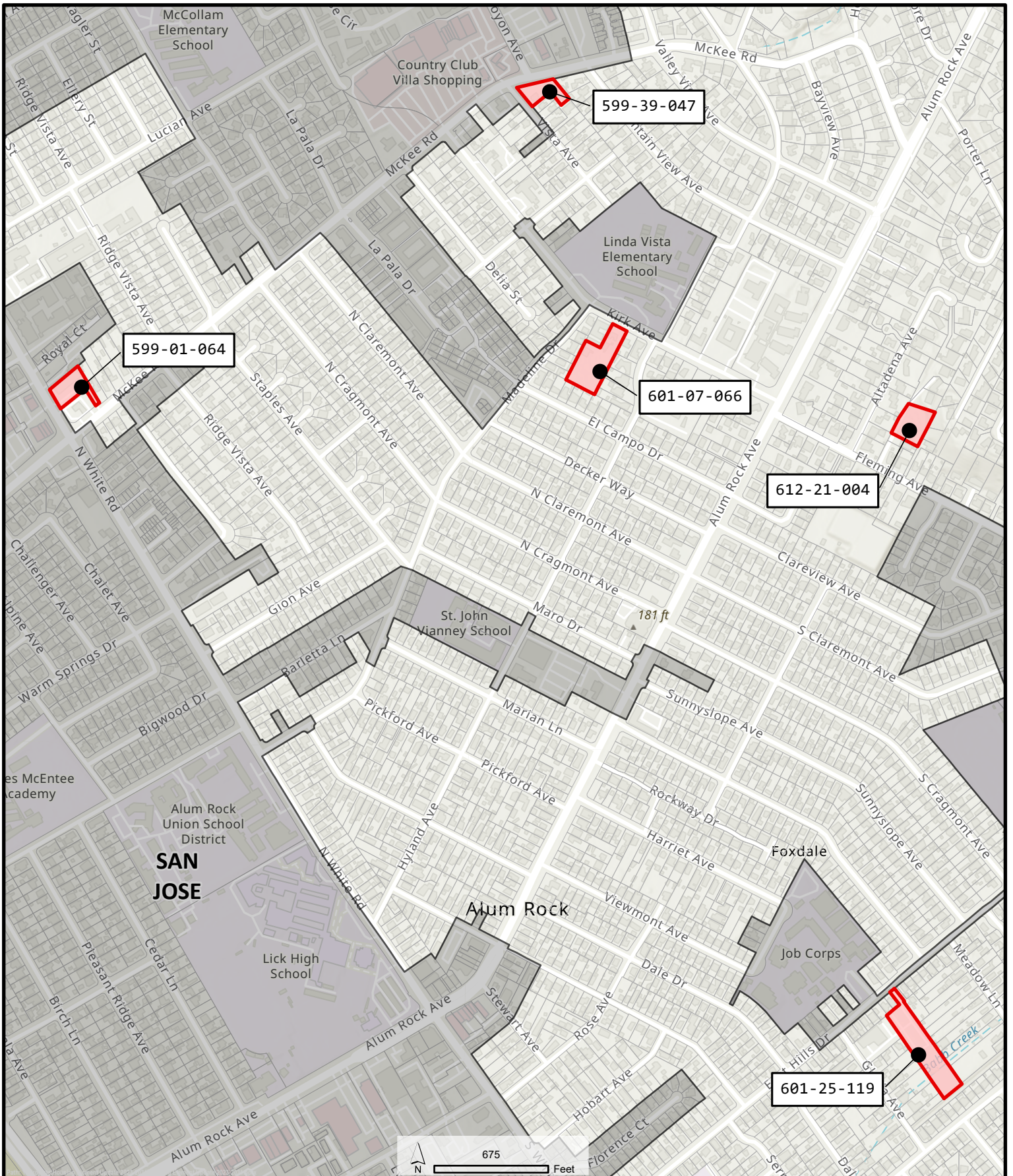

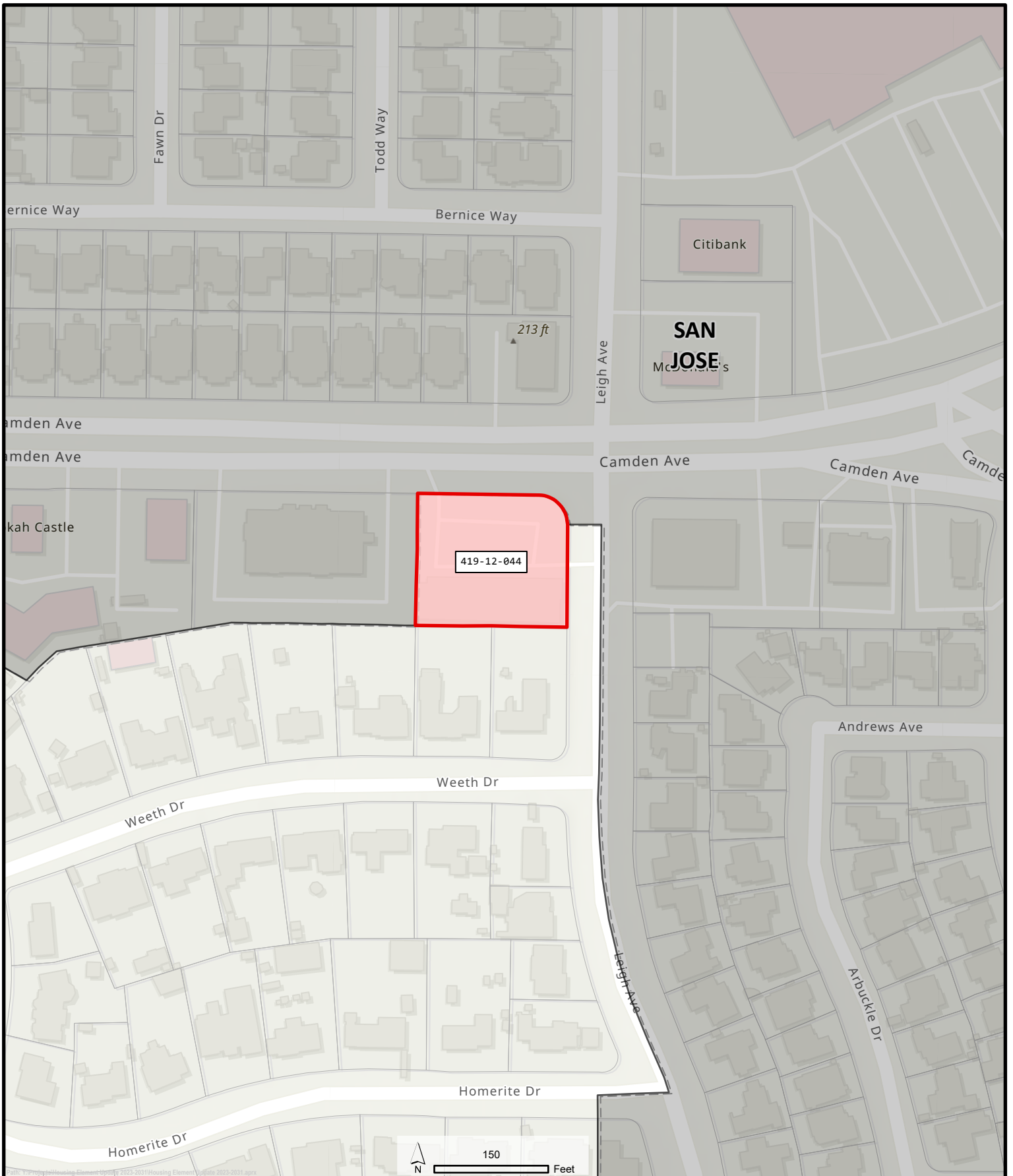

County of Santa Clara  
 Housing Element Update 2023-2031  
**Alum Rock/East Foothills**

- os Housing Opportunity
- Site Combining District
- Urban Service Areas
- City Limits



County of Santa Clara  
 Housing Element Update 2023-2031  
**Cambrian Park**

-  -os Housing Opportunity Site Combining District
-  Urban Service Areas
-  City Limits



County of Santa Clara  
 Housing Element Update 2023-2031  
**Escondido Village**

- os Housing Opportunity Site Combining District
- Urban Service Areas
- City Limits

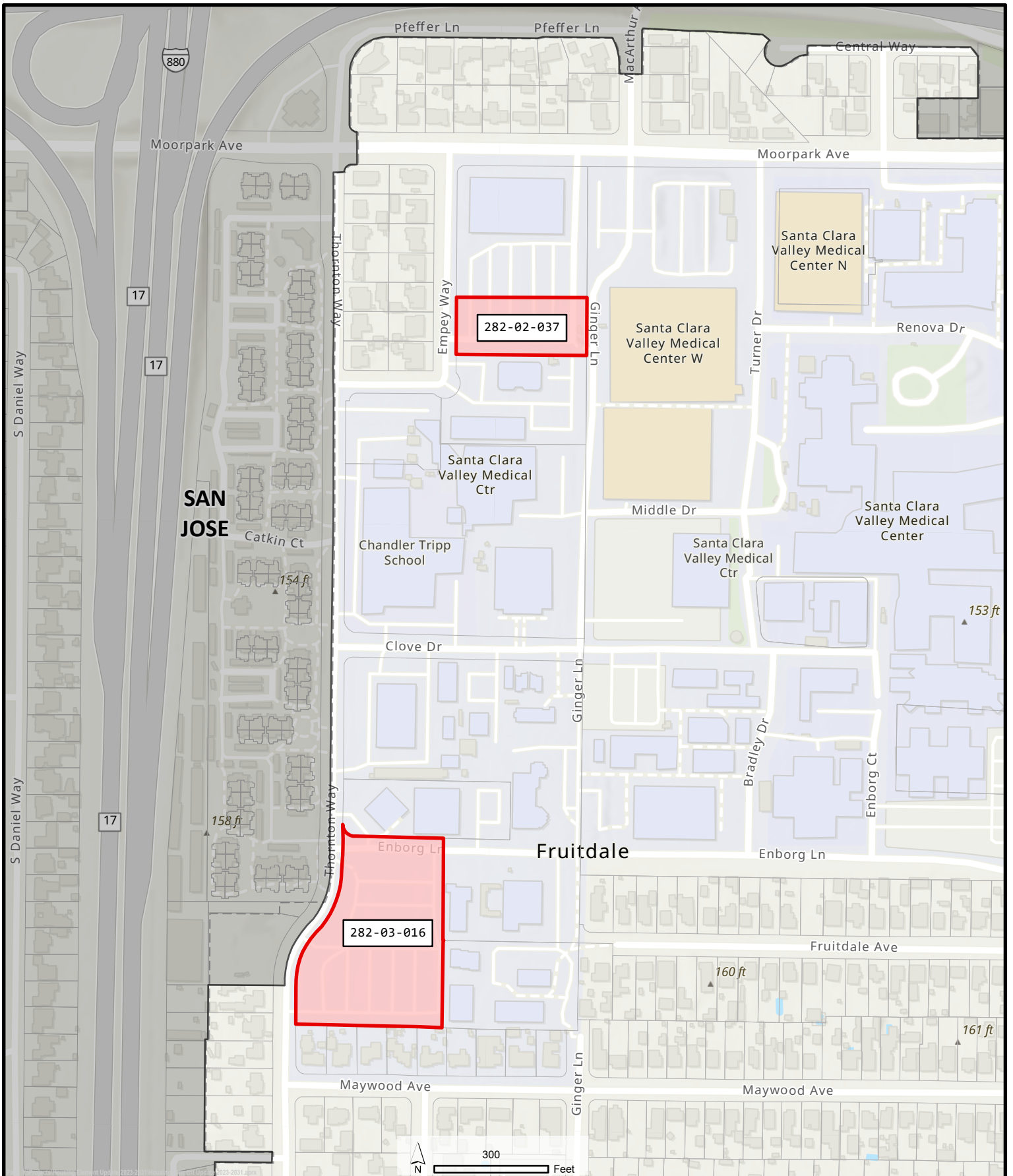

County of Santa Clara  
 Housing Element Update 2023-2031  
**Fruitdale/Santa Clara Valley Medical Center**

- os Housing Opportunity Site Combining District
- Urban Service Areas
- City Limits



County of Santa Clara  
 Housing Element Update 2023-2031  
**Hostetter Station**

- os Housing Opportunity
- Site Combining District
- Urban Service Areas
- City Limits



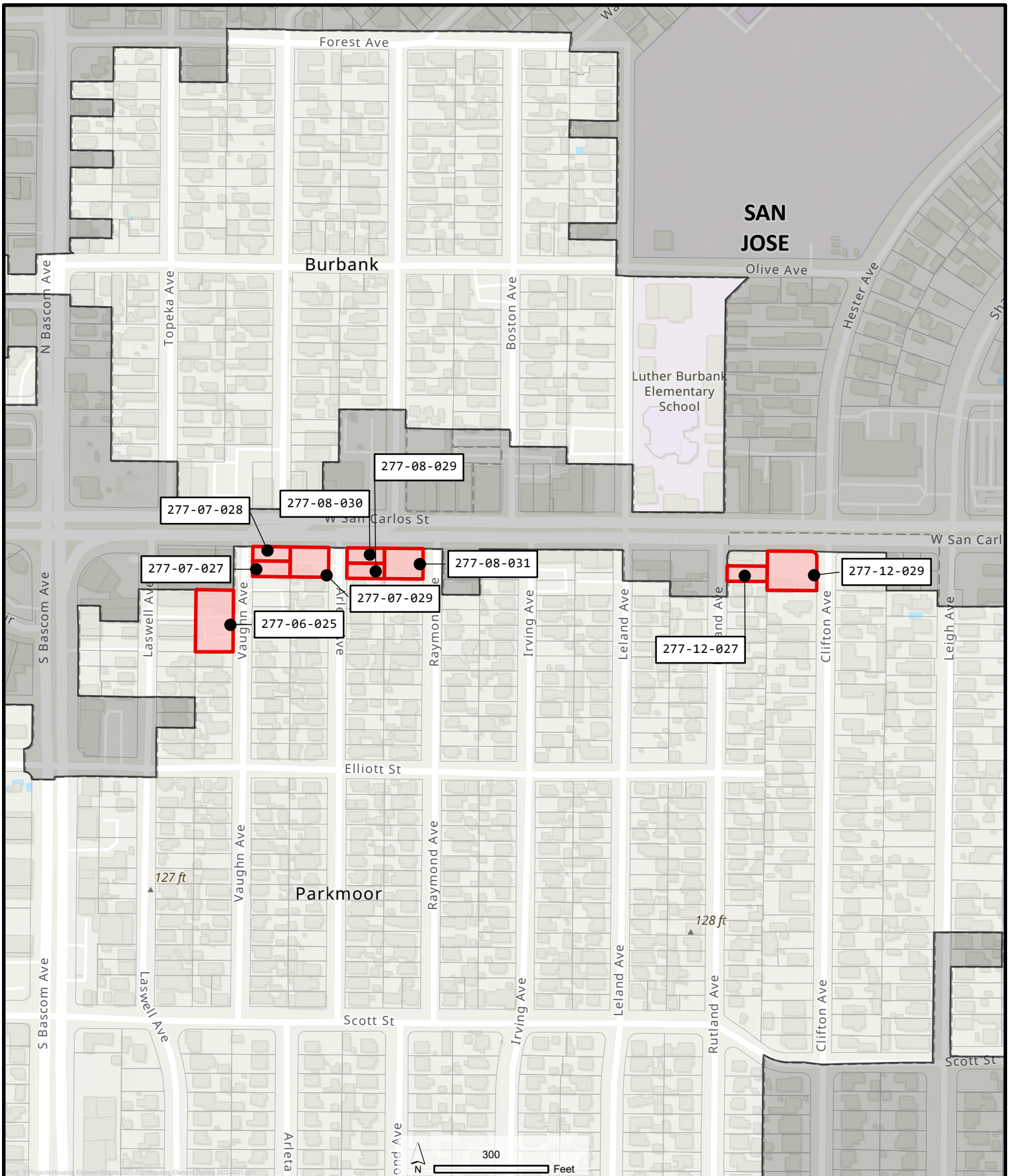

County of Santa Clara  
 Housing Element Update 2023-2031  
**Parkmoor/Burbank Neighborhood**

- os Housing Opportunity
- Site Combining District
- Urban Service Areas
- City Limits

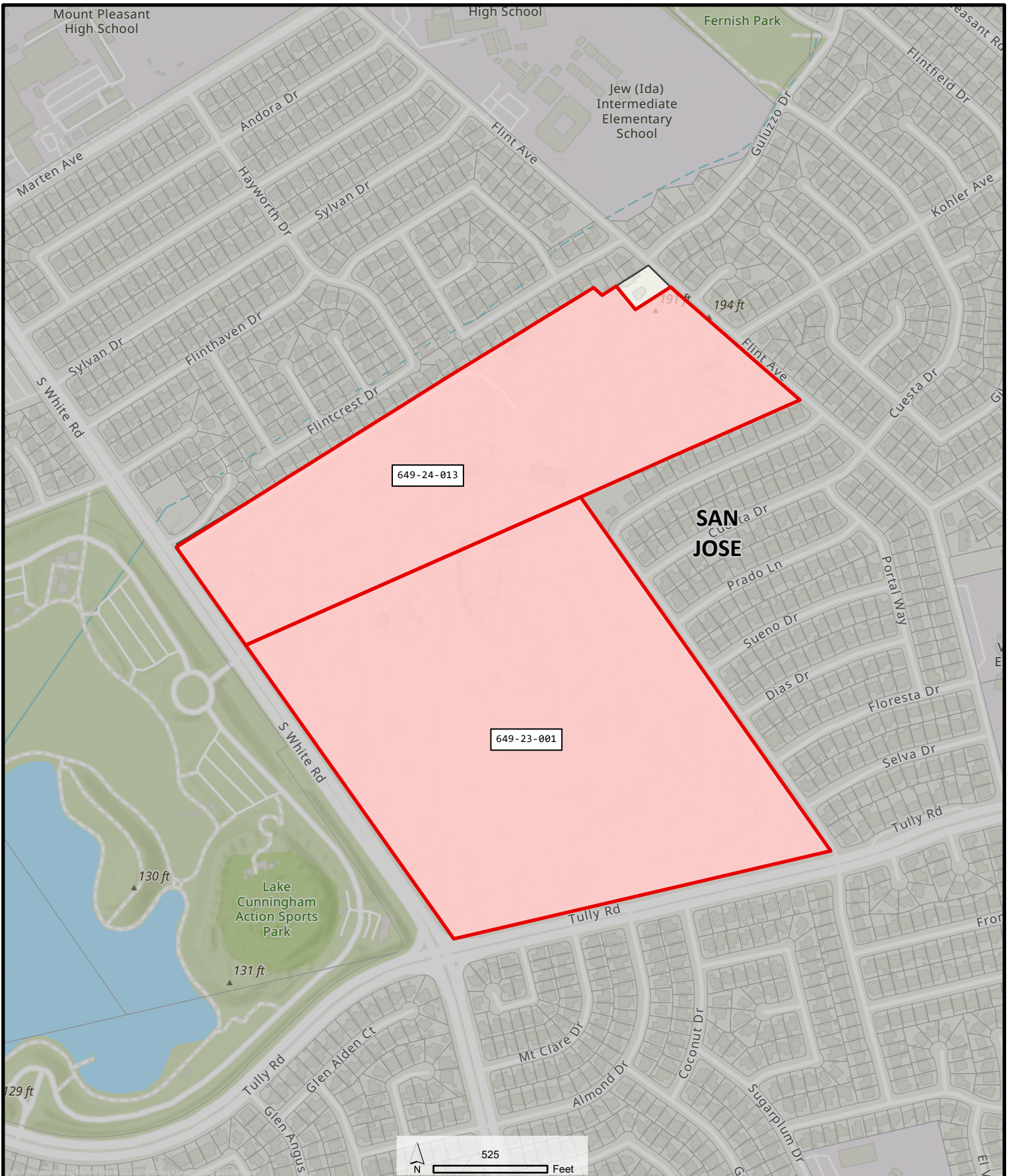

County of Santa Clara  
Housing Element Update 2023-2031  
**Pleasant Hills**

- os Housing Opportunity Site Combining District
- Urban Service Areas
- City Limits

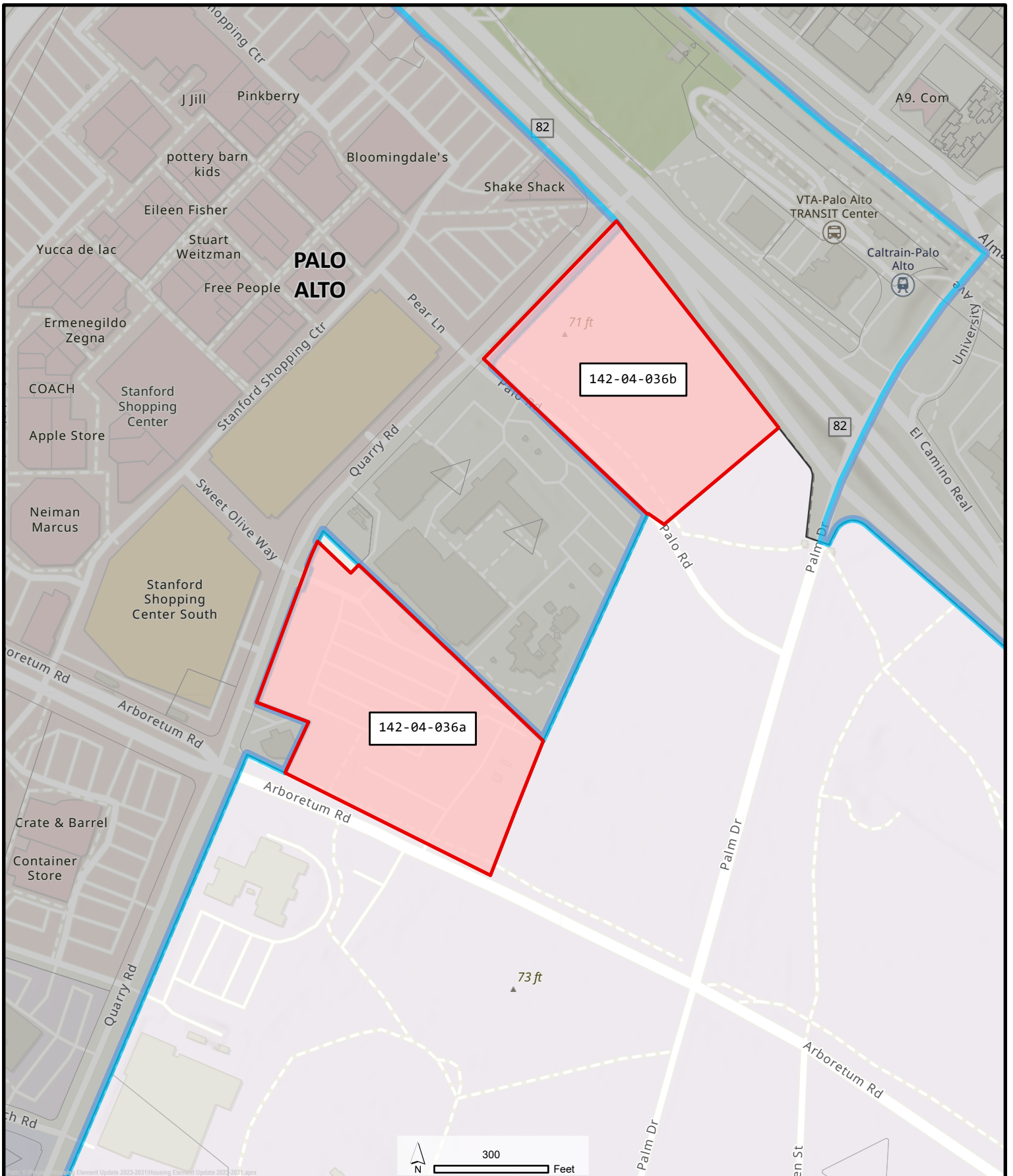

County of Santa Clara  
 Housing Element Update 2023-2031  
**Quarry - Arboretum/El Camino**

- os Housing Opportunity
- Site Combining District
- Urban Service Areas
- City Limits