

# Lot Merger Site Map

All site maps for Lot Mergers shall show the following:

- Owner's name, engineer's name (if applicable), scale, north arrow, and date of preparation.
- A vicinity map showing sufficient information to easily locate subject property.
- Dimensioned boundaries of subject parcel.
- Location of existing and proposed easements, improvements, access, and structures.
- Accurate contour lines showing contours at reasonable intervals on lands with slope greater than five percent.

Additional information may be required, depending on specific circumstances of property.

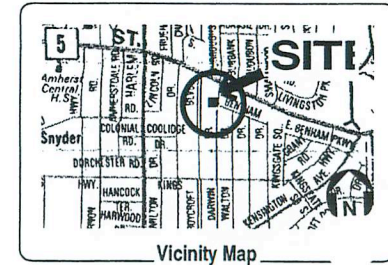
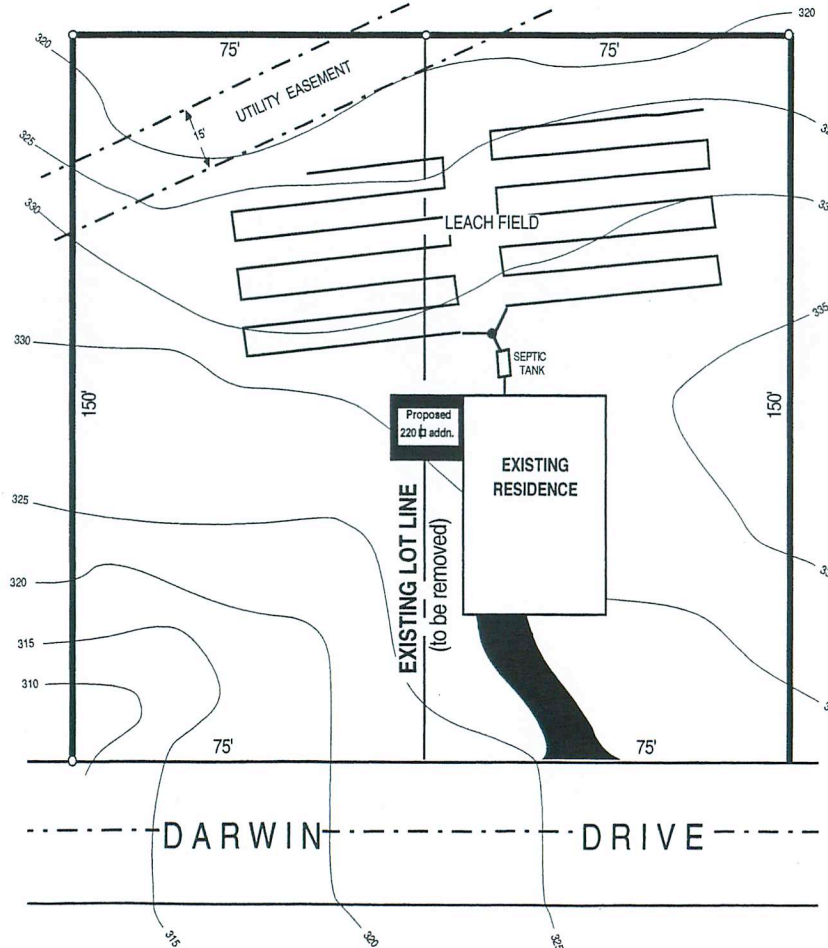

SCALE: 1" = 40'

APN: 999-99-999

PREPARED BY: Travis Bickle

FEBRUARY 1990