

LEGEND

- Existing Structure
- Existing Concrete

Applicant/Owner:
 Richard Infantino
 104 Beachgate Way
 Aptos, CA 95003
 408.206.1605
 nancyinfantino@gmail.com

Engineer:
 William J. McClintock RCE 24893
 MH Engineering
 16075 Vineyard Blvd.
 Morgan Hill, CA 95037
 408.779.7381
 billm@mhengineering.com

Project Information:
 APN 274-41-068
 Present Use:
 Burbank Sanitary District
 PG&E

Commercial
 CG
 Burbank Sanitary District
 PG&E

Telephone:
 Existing Improvements:
 Area:

As Shown
 0.13 ac

Boundary Note: Property lines shown on this plan are based on record data from lot 40 of record map L. M. 91.

Flood Zone: The property lies wholly in Zone D, areas in which flood hazards are undetermined, but possible, per FEMA Firm Panel 06085C0233H, effective May 18, 2009.

Basis of Bearings: The bearings shown on this map are based on the centerline of Stevens Creek Blvd. (S89°00'25"W) as shown on that certain Record of Survey filed for record in Book 235 of Maps at Page 7 of Santa Clara County.

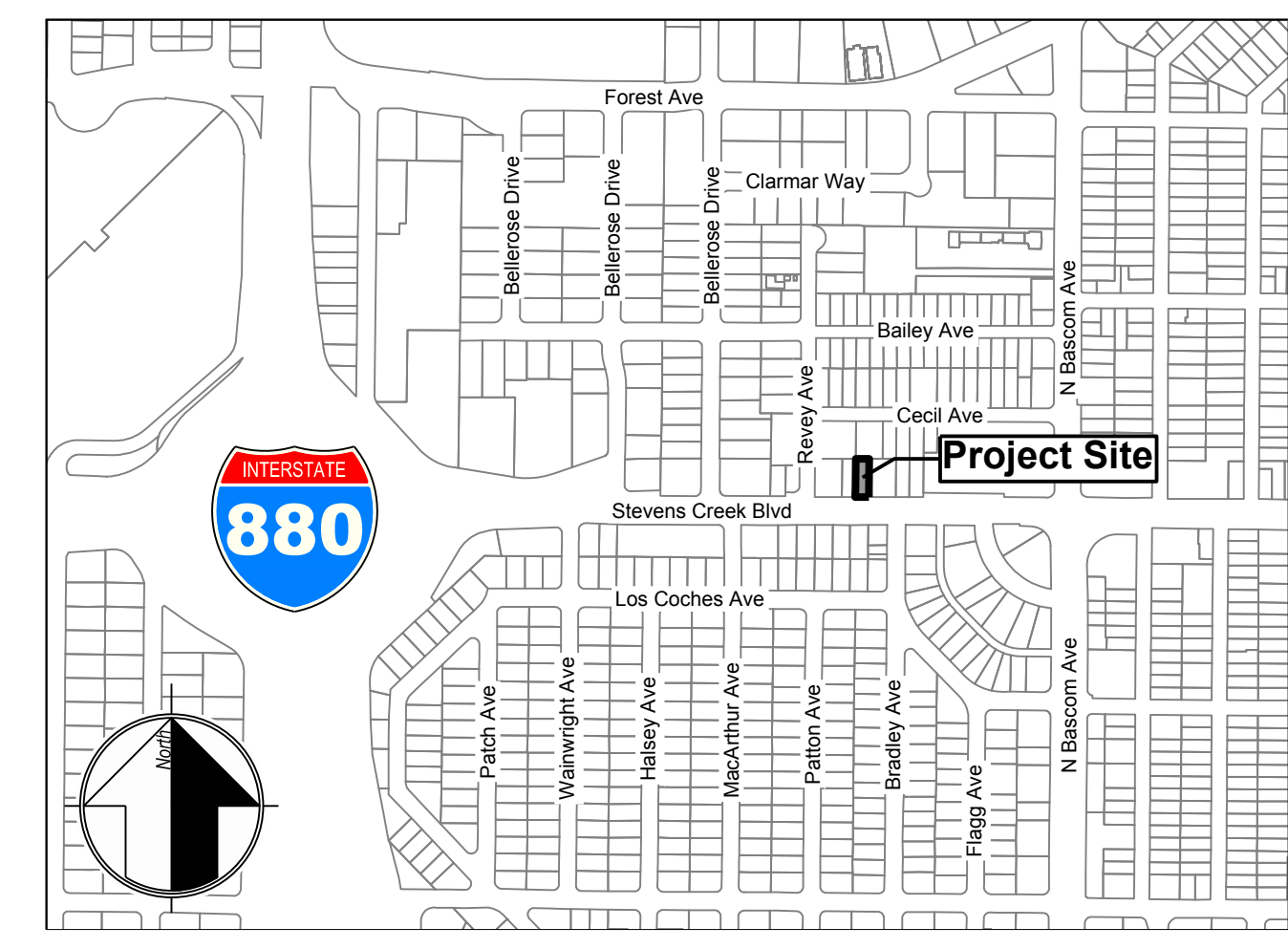

Vicinity Map

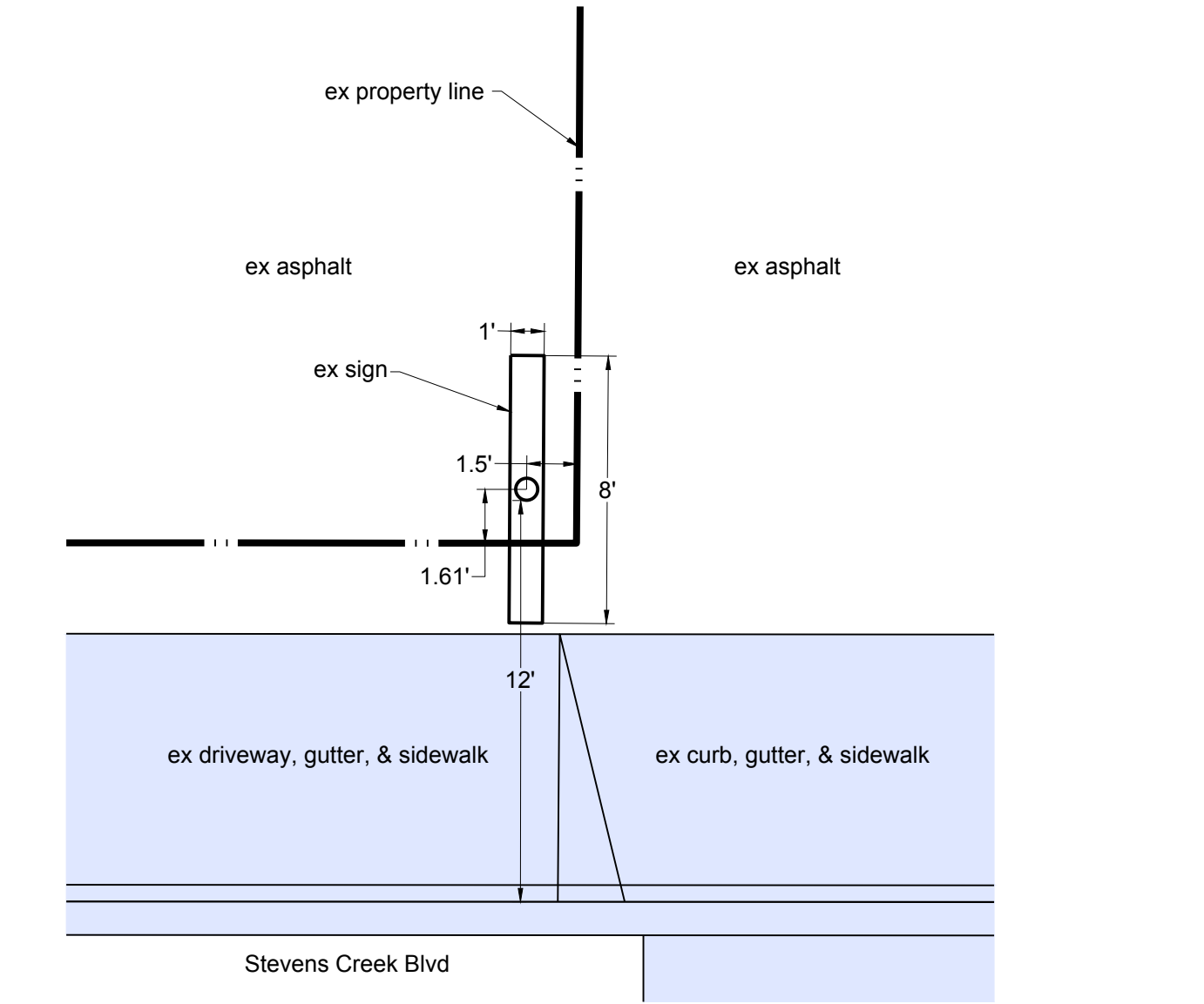

Sign Plan View
 Scale: 1" = 5'

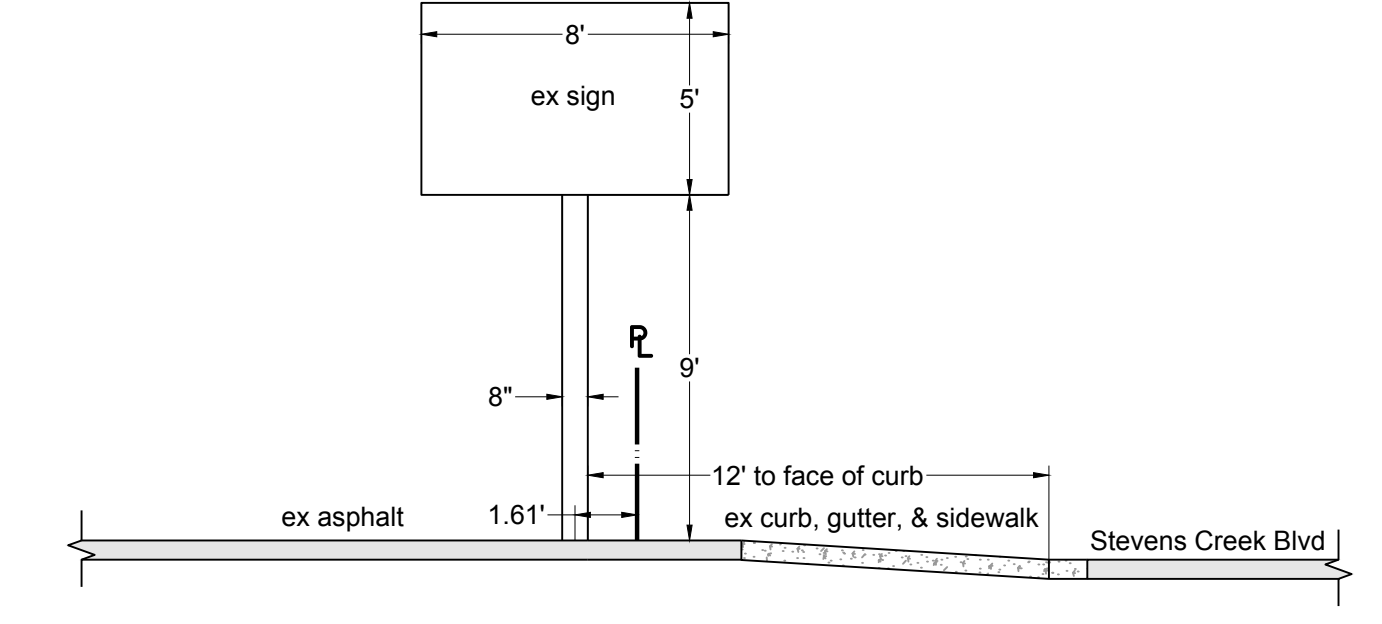

West Sign Elevation
 Scale: 1" = 5'



West Sign Elevation Image

