

**LINE DATA**

LINE NO.	BEARING	DISTANCE
L1	N 23° 49' 00\"	70.00'

**PROJECT NOTES**

SUBDIVISION NAME: 12400 COLUMBET PARCEL MAP  
 PROPOSED TWO-LOT SUBDIVISION  
 OWNER/SUBDIVIDER: LIN MON FONG  
 6197 MCABEE ROAD  
 SAN JOSE, CA 95130  
 (408) 899-2200

LAND SURVEYOR: *Michael J. Carnes*  
 CARNES & EKPARIAN, INC.  
 9505 SUGAR BABE DRIVE  
 GILROY, CA 95020  
 (408) 847-2013

LEGAL DESIGNATION: LOT 154-A, "G"-M-69  
 LOC. 825-23-011  
 LEGAL DEED: 825-23-011

EXISTING ZONING: RR-5AC - RURAL-RESIDENTIAL 5 ACRE  
 NO EXISTING STRUCTURES OR WELLS ARE TO REMAIN.  
 PROPOSED USE: DIVIDE INTO TWO (2) FIVE-ACRE PARCELS. NO RESTRICTIONS ARE PROPOSED.

PROPOSED PUBLIC AREAS: THERE ARE NO PUBLIC AREAS PROPOSED.  
 DEDICATIONS: THERE IS A PROPOSED 33 FOOT DEDICATION FOR THE COLUMBET AVENUE. THERE IS A PROPOSED 26 FOOT DEDICATION WITH A 42' CUL-DE-SAC TO COMPLETE HOGUE COURT.  
 GEOLOGICAL HAZARDS: NO GEOLOGICAL HAZARDS.

**ABBREVIATIONS**

- PRIVATE UTILITY EASEMENT
- STORM DRAIN EASEMENT
- PROPERTY BOUNDARY
- LOT LINE
- EASEMENT
- PROPOSED EASEMENT
- PROPOSED DEDICATION
- LIP OF CUTTER/PAVEMENT

**LEGEND**

- PROPERTY BOUNDARY
- LOT LINE
- EASEMENT
- PROPOSED EASEMENT
- PROPOSED DEDICATION
- LIP OF CUTTER/PAVEMENT

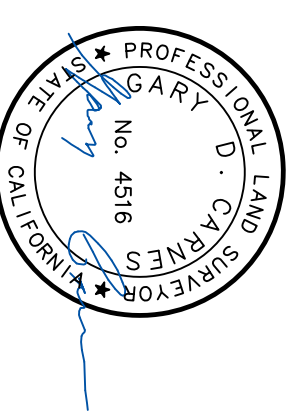

SHEET <b>1</b> OF <b>1</b>	DATE : 05/25/2020
	SCALE : 1" = 50'
	DRAWN BY : D.E.
	PROJ. MANAGER : G.C.

**TENTATIVE PARCEL MAP FOR LIN MON FONG LOT 154-A, "G"-M-69 COUNTY OF SANTA CLARA, CA.**

No.	DATE	REVISION
1.	9/23/20	DELETED PROPOSED CUL-DE-SAC DEDICATION
2.	12/03/20	DELETED PROPOSED HOGUE COURT DEDICATION & UPDATED PARCEL 1 ACRAGE.



**Carnes & Ekparian, Inc.**  
 LAND SURVEYORS  
 9505 SUGAR BABE DRIVE GILROY, CA 95020  
 T: (408) 847-2013 F: (408) 846-7248  
 EMAIL: OFFICE@CE-PLS.COM