

COUNTY OF SANTA CLARA

General Construction Specifications

GENERAL CONDITIONS

- 1. ALL CONSTRUCTION WORK SHALL BE PERFORMED IN ACCORDANCE WITH THE GEOLOGIC UPDATE INVESTIGATION REPORT PREPARED BY STEVEN F. CONNELLY, G.E.G., DATED JUNE 15, 2018...

GRADING

- 1. EXCAVATED MATERIAL SHALL BE PLACED IN THE FILL AREAS DESIGNATED OR SHALL BE HAULED AWAY FROM THE SITE TO A COUNTY-APPROVED DISPOSAL SITE...

Table with 4 columns: LOCATION, CUT (C.Y.), FILL (C.Y.), VERT. DEPTH. Row 1: RESIDENCE, 20, 40, 1.0. Row 2: TOTAL, 20, 40, 1.0.

- NOTES: 1. EARTHWORK QUANTITIES INCLUDE BOTH WORK THAT WAS ALREADY COMPLETED ON THE PROPERTY THAT WAS NOT PERMITTED AND WORK COMPLETED UNDER THE PREVIOUS GRADING PERMIT...

CONSTRUCTION STAKING

- 1. THE DEVELOPER'S ENGINEER IS RESPONSIBLE FOR THE INITIAL PLACEMENT AND REPLACEMENT OF CONSTRUCTION GRADE STAKES...

CONSTRUCTION INSPECTION

- 1. CONTRACTOR SHALL NOTIFY PERMIT INSPECTION UNIT, SANTA CLARA COUNTY PRIOR TO COMMENCING WORK AND FOR FINAL INSPECTION OF WORK AND SITE...

SITE PREPARATION (CLEARING AND GRUBBING)

- 1. EXISTING TREES AUTHORIZED FOR REMOVAL, ROOTS, AND FOREIGN MATERIAL IN AREAS TO BE IMPROVED WILL BE REMOVED TO AN AUTHORIZED DISPOSAL SITE...

UTILITY LOCATION, TRENCHING & BACKFILL

- 1. CONTRACTOR SHALL NOTIFY USA (UNDERGROUND SERVICE ALERT) AT 1-800-277-2600 A MINIMUM OF 24 HOURS BEFORE BEGINNING UNDERGROUND WORK...

RETAINING WALLS

- 1. REINFORCED CONCRETE AND CONCRETE MASONRY UNIT RETAINING WALLS SHALL HAVE FOUNDATION AND REINFORCEMENT INSPECTED BY THE COUNTY ENGINEERING INSPECTOR...

AIR QUALITY, LANDSCAPING AND EROSION CONTROL

- 1. WATER ALL ACTIVE CONSTRUCTION AREAS AT LEAST TWICE DAILY. 2. COVER ALL TRUCKS HAULING SOIL, SAND, AND OTHER LOOSE MATERIALS OR REUSE ALL TRUCKS TO MAINTAIN AT LEAST TWO FEET OF TREAD...

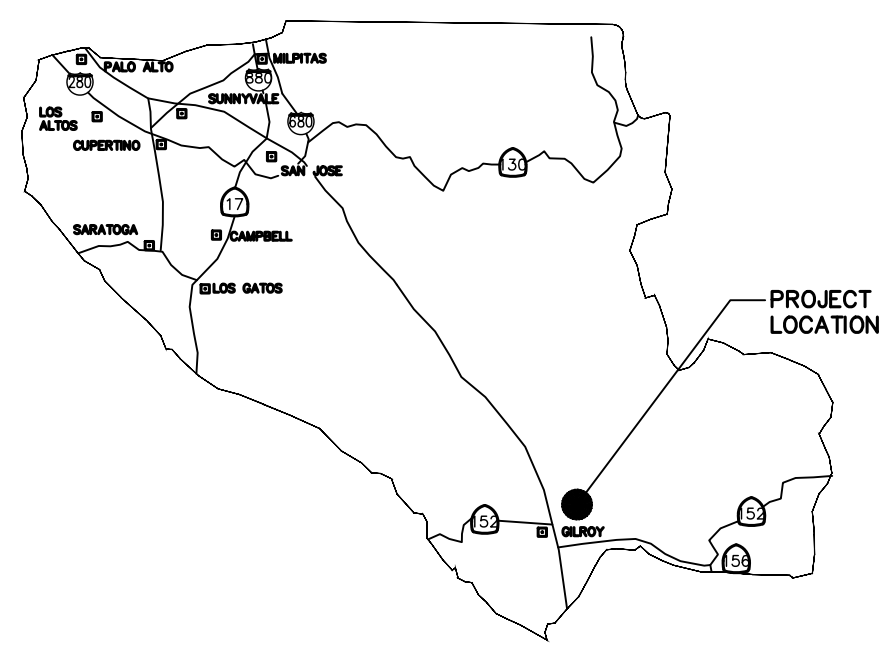

COUNTY LOCATION MAP

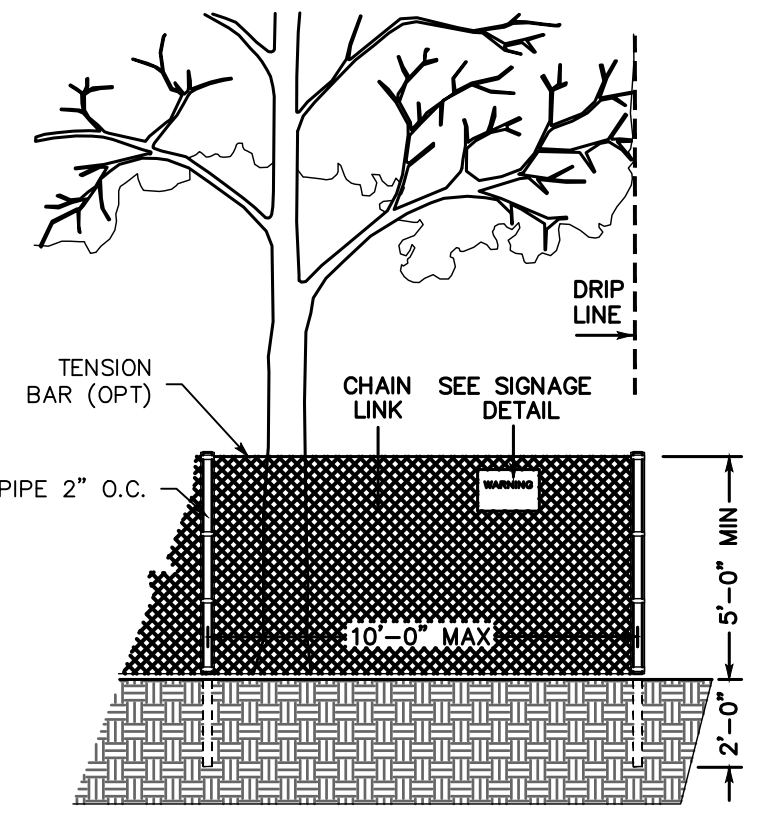

EXISTING TREE PROTECTION DETAILS

- 1. PRIOR TO THE COMMENCEMENT OF ANY GRADING, TREE PROTECTIVE FENCING SHALL BE IN PLACE IN ACCORDANCE WITH THE TREE PRESERVATION PLAN...

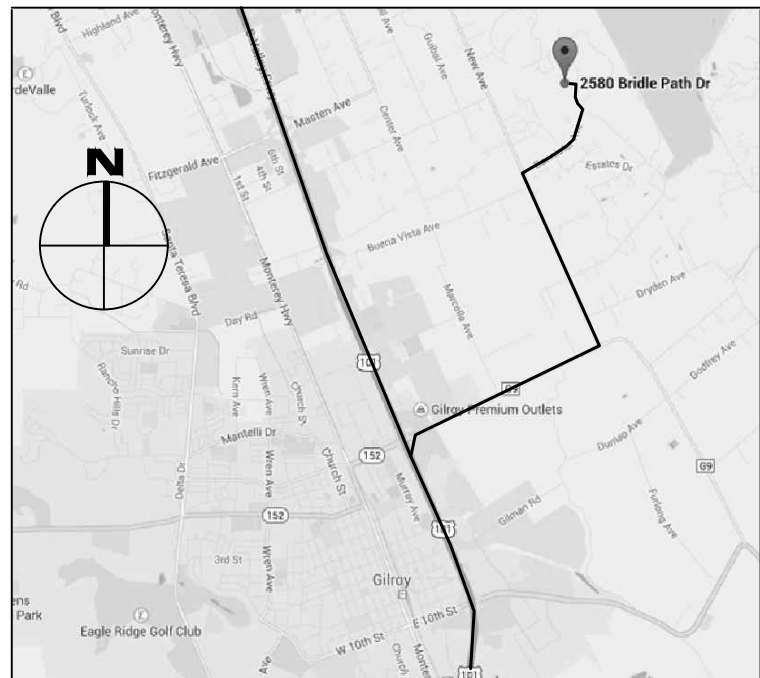

VICINITY MAP

SURVEY MONUMENT PRESERVATION

- 1. THE LANDOWNER / CONTRACTOR MUST PROTECT AND ENSURE THE PERPETUATION OF SURVEY MONUMENTS AFFECTED BY CONSTRUCTION ACTIVITIES...

COUNTY OF SANTA CLARA DEPT. OF ROADS AND AIRPORTS. ISSUED BY: DATE: ENCROACHMENT PERMIT NO.

COUNTY OF SANTA CLARA LAND DEVELOPMENT ENGINEERING & SURVEYING. GRADING / DRAINAGE PERMIT NO. ISSUED BY: DATE:

STORM DRAINAGE AND STORMWATER MANAGEMENT

- 1. DEVELOPER IS RESPONSIBLE FOR ALL NECESSARY DRAINAGE FACILITIES WHETHER SHOWN ON THE PLANS OR NOT AND HE OR HIS SUCCESSOR PROPERTY OWNERS ARE RESPONSIBLE FOR THE ADEQUACY AND CONTINUED MAINTENANCE OF THESE FACILITIES...

AS-BUILT PLANS STATEMENT

THIS IS A TRUE COPY OF THE AS-BUILT PLANS. THERE (\_\_\_ WERE) (\_\_\_ WERE NOT) MINOR FIELD CHANGES - MARKED WITH THE SYMBOL (\*). THERE (\_\_\_ WERE) (\_\_\_ WERE NOT) PLAN REVISIONS INDICATING SIGNIFICANT CHANGES REVIEWED BY THE COUNTY ENGINEER AND MARKED WITH THE SYMBOL Δ.

STREET LIGHTING

- 1. PACIFIC GAS & ELECTRIC ELECTROLETR SERVICE FEE SHALL BE PAID BY THE DEVELOPER AND/OR HIS AUTHORIZED REPRESENTATIVE.

SANITARY SEWER

- 1. THE SANITARY SEWER AND WATER UTILITIES SHOWN ON THESE PLANS ARE NOT PART OF THIS GRADING PERMIT AND ARE SHOWN FOR REFERENCE ONLY.

PORTLAND CEMENT CONCRETE

- 1. CONCRETE USED FOR STRUCTURAL PURPOSES SHALL BE CLASS "A" (6 SACK PER CUBIC YARD) AS SPECIFIED IN THE STATE STANDARD SPECIFICATIONS.

COUNTY ENGINEER'S NOTE

ISSUANCE OF A PERMIT AUTHORIZING CONSTRUCTION DOES NOT RELEASE THE DEVELOPER, PERMITTEE OR ENGINEER FROM RESPONSIBILITY FOR THE CORRECTION OF ERRORS OR OMISSIONS CONTAINED IN THE PLANS...

DARRELL KEITH WONG. 63958. 9/30/2024. R.C.E. NO. EXPIRATION DATE.



SHEET INDEX

Table with 3 columns: Sheet No., Description, and Date. Includes sheets for COVER SHEET, SITE PLAN, GRADING AND DRAINAGE PLAN, SECTIONS, DRIVEWAY PROFILE, DRAINAGE CONTROL PLAN, and BEST MANAGEMENT PRACTICES SHEETS.

APPLICANT: SAL AKHTER

ROAD: 2580 BRIDLE PATH DR

COUNTY FILE NO.: PLN23-023 (SFR)

LANDS OF SAL AKHTER SINGLE FAMILY RESIDENCE

2580 BRIDLE PATH DRIVE PLN23-023

SCOPE OF WORK

THE SFR PROJECT PROPOSES THE FOLLOWING:

GRADING AND DRAINAGE FOR NEW SINGLE FAMILY RESIDENCE. CONVERT (E) RESIDENCE TO NON-HABITABLE STRUCTURE.

WORK TO BE COMPLETED UNDER SEPARATE PERMITS

- 1. DEV22-2374: RELOCATE (E) ADU. 2. PERMIT NO. 6201485: PAVING OF DRIVEWAYS AND FIRE TURNOUTS AND TURNAROUNDS. PERMIT TO BE REACTIVATED WITH THE COUNTY. 3. DEV23-0546: GRADING AND STREAM RELOCATION AND REHABILITATION, SLOPE STABILIZATION, REMOVAL OF PONDS AND NATURAL LANDSCAPING



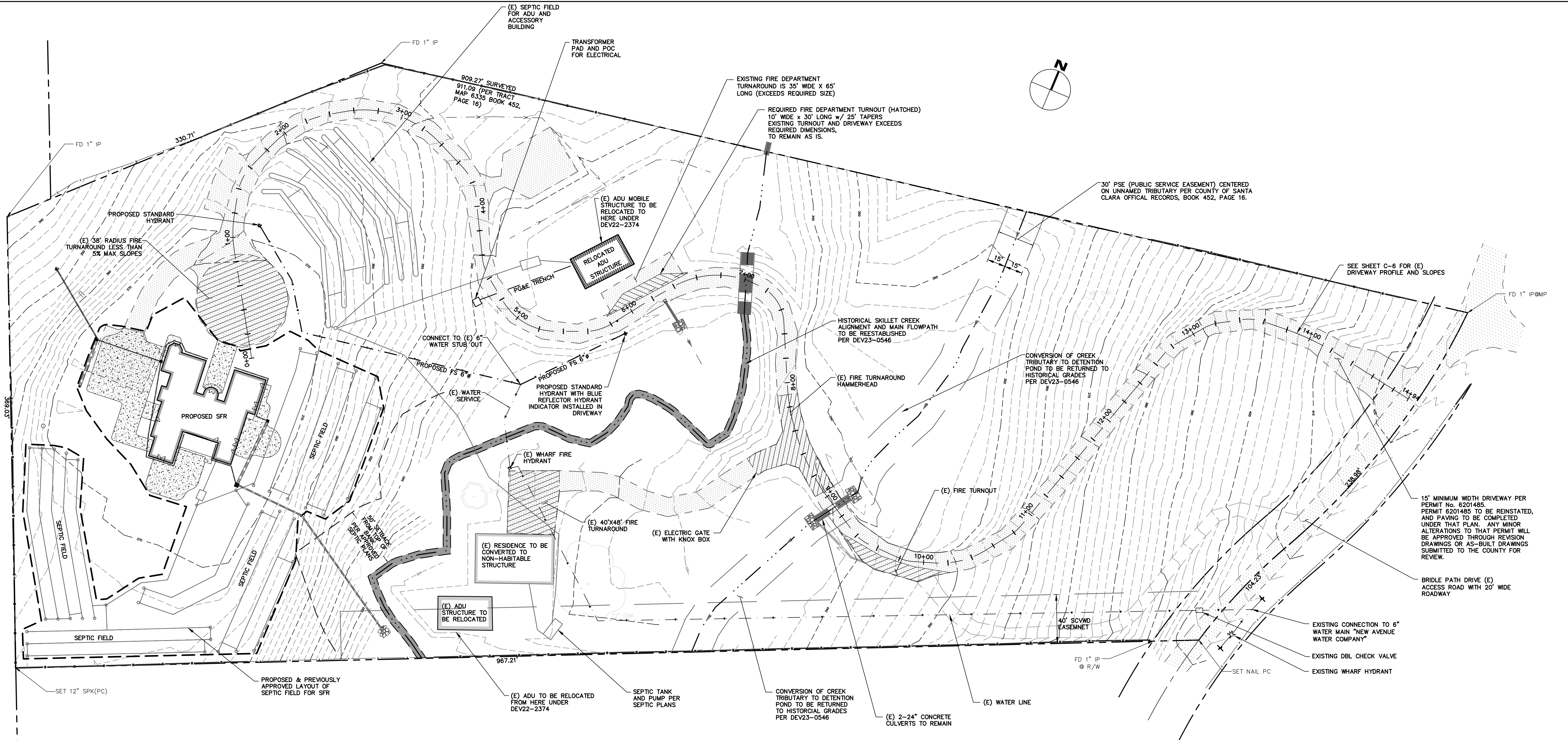

**TOPOGRAPHIC SURVEY**

THE TOPOGRAPHIC SURVEY AND BOUNDARY INFORMATION PROVIDED HEREON WAS COMPLETED BY CARNES AND ASSOCIATES. RI ENGINEERING INC. MAKES NO GUARANTEE AS TO THE ACCURACY OF BOTH. THE CONTRACTOR SHALL VERIFY THE BOUNDARY LOCATION AND TOPOGRAPHIC INFORMATION PRIOR TO COMMENCING WORK.

**BASIS OF BEARINGS**

THE BEARINGS SHOWN ON THIS MAP ARE BASED ON THE NORTHWESTERLY LINE OF LOT 25, AS SHOWN ON THE MAP RECORDED IN THE BOOK 452 OF MAPS, AT PAGES 16-19, SANTA CLARA COUNTY RECORDS.

**BASIS OF ELEVATIONS**

TOP OF MONUMENT BOX AT NORTHWESTERLY CORNER OF LOT 25, TRACT 6335, AT THE CENTERLINE OF BRIDLE PATH DRIVE AND BUTCH DRIVE. EL=424.16

**ABBREVIATIONS**

C	CENTERLINE
DTL	DETAIL
DWY	DRIVEWAY
(E)	EXISTING
EL	ELEVATION
NTS	NOT TO SCALE
S	SLOPE
SCCO	SANTA CLARA COUNTY
STA	STATION
TYP	TYPICAL

**LEGEND**

	(E) AB		(E) FLOWLINE
	EXISTING OIL AND SCREEN DRIVEWAY UNDER PERMIT 8204185		(E) RETAINING WALL
	PROPOSED AC		PROPERTY LINE
	(E) CONCRETE		PROPOSED LIMIT OF DISTURBANCE
			PROPOSED CREEK CENTERLINE
			PROPOSED SETBACK

**IMPERVIOUS AREA CALCULATIONS**

<b>NEW IMPERVIOUS</b>	
HOUSE	4,925 SF
CONCRETE FLATWORK	5,060 SF
<b>REPLACED IMPERVIOUS</b>	
CONCRETE FLATWORK	1,880 SF
<b>TOTAL NEW AND REPLACED IMPERVIOUS</b>	<b>11,865 SF</b>







**FIRE MARSHAL NOTES**

PROJECT IS LOCATED WITHIN THE STATE RESPONSE AREA (SRA) AND THE WILDLAND URBAN INTERFACE (WUI).  
 B.CHAPTER 7A OF THE CBC TO BE MET AT BUILDING PERMIT SUBMITTAL.  
 C.DEFENSIBLE SPACE TO BE MAINTAINED AT ALL TIMES.  
 D.FIRE-4290 COMPLIANCE WILL BE REVIEWED BY CAL FIRE.  
 E.SHEET 1 OF 10 REFERENCES THE PREVIOUS CODE CYCLE. THIS PLAN REVIEW IS BEING CONDUCTED OFF THE 2022 OFC AND LOCAL ORDINANCE.  
 F.FIRE SPRINKLERS ARE TO BE LISTED AS A DEFERRED SUBMITTAL.  
 DRIVEWAY IS OF ALL WEATHER MATERIAL CAPABLE OF HOLDING 75,000 LB FIRE TRUCK LOADING. (IT HAS MULTIPLE TIMES BEEN USED BY CALFIRE AS A STAGING AREA)

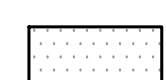
	303 Potrero St., Suite 42-202, Santa Cruz, CA 95060 831-425-9901 www.riengineering.com
SINGLE FAMILY RESIDENCE FOR SAL AKHTER 2580 BRIDLE PATH DR GILROY, CALIFORNIA APN: 850-17-059	<b>SITE PLAN</b>
project no.	14-067-2
date	MARCH 2024
scale	AS SHOWN
dwg name	CIVIL-STREAM.DWG
C-1	

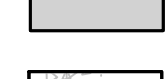

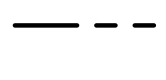
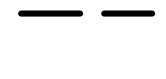
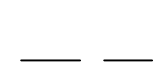
**LEGEND**

-  (E) AB
-  EXISTING OIL AND SCREEN DRIVEWAY UNDER PERMIT 6204185
-  PROPOSED AC
-  (E) CONCRETE
-  (E) FLOWLINE
-  (E) RETAINING WALL
-  PROPERTY LINE
-  PROPOSED LIMIT OF DISTURBANCE
-  PROPOSED CREEK CENTERLINE
-  PROPOSED SETBACK

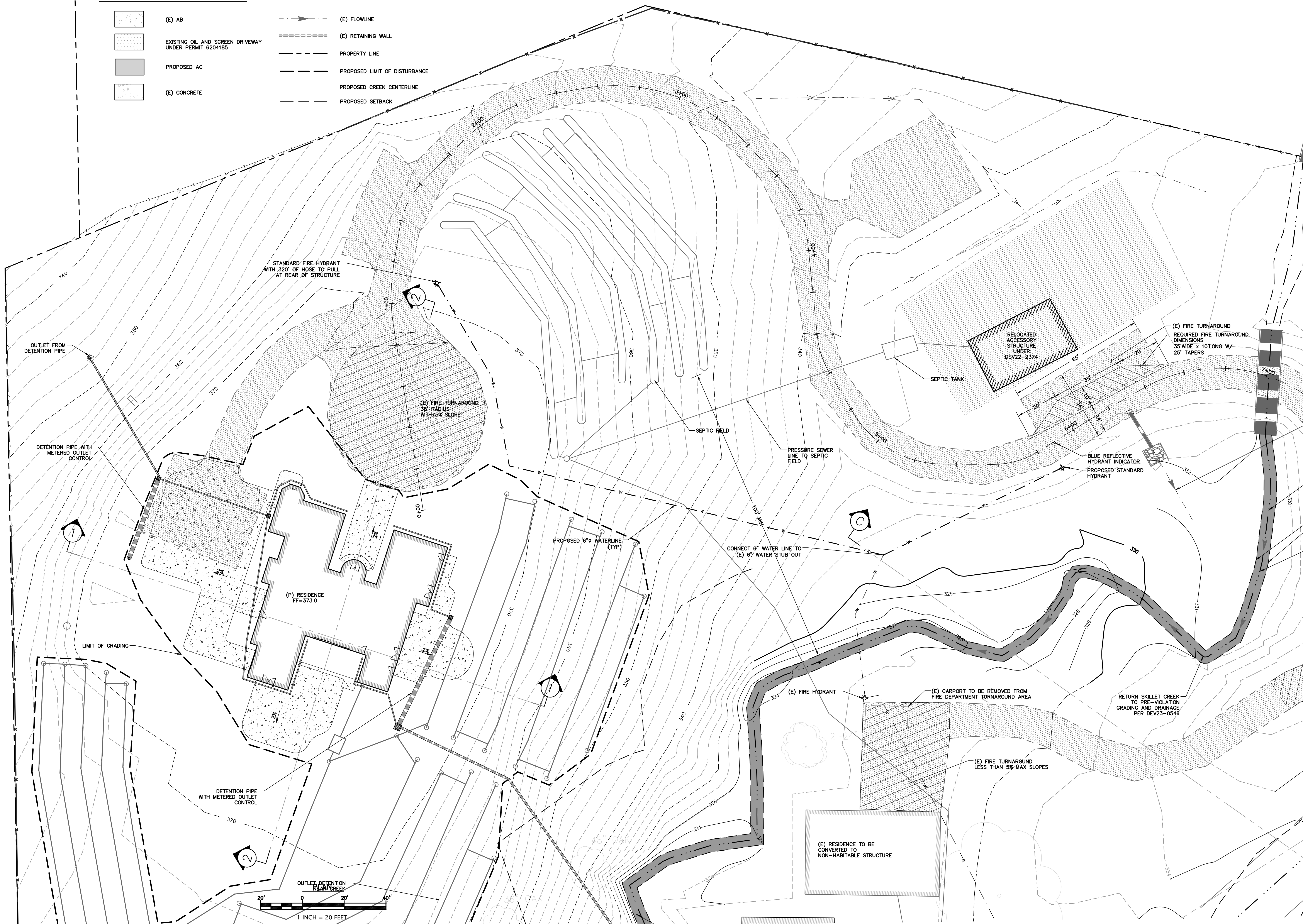

**RI Engineering, Inc.**  
 303 Potrero St., Suite 42-202, Santa Cruz, CA 95060  
 831-425-3901 www.riengineering.com

SINGLE FAMILY RESIDENCE  
 FOR  
 SAL AKHTER  
 2580 BRIDLE PATH DR  
 GILROY, CALIFORNIA  
 APN: 880-17-059

**GRADING AND DRAINAGE PLAN**  
 project no. 14-067-2  
 date MARCH 2024  
 scale AS SHOWN  
 dwg name CIVIL-STREAM.DWG

**C-2**



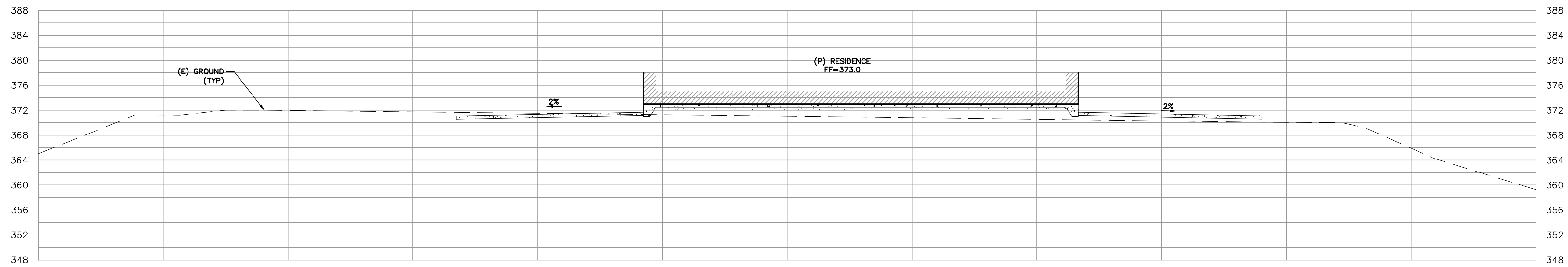

SECTION 1-1  
SCALE: 1"=20' HORIZONTAL, VERTICAL

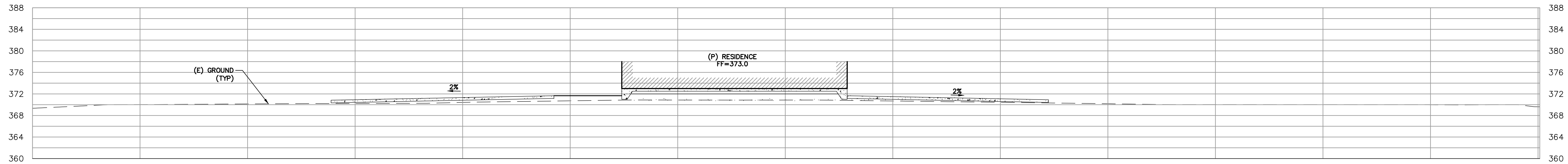

SECTION 2-2  
SCALE: 1"=20' HORIZONTAL, VERTICAL

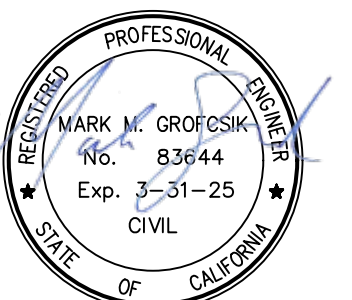

3/8/2024



**RI Engineering, Inc.**

303 Potrero St., Suite 42-202, Santa Cruz, CA 95060  
831-425-9901 www.rengineering.com

SINGLE FAMILY RESIDENCE  
FOR  
SAL AKHTER  
2580 BRIDLE PATH DR  
GILROY, CALIFORNIA  
APN: 850-17-059

DETAILS AND SECTIONS

project no.  
14-067-2  
date  
MARCH 2024  
scale  
AS SHOWN  
dwg name  
CIVIL-STREAM.DWG

C-3

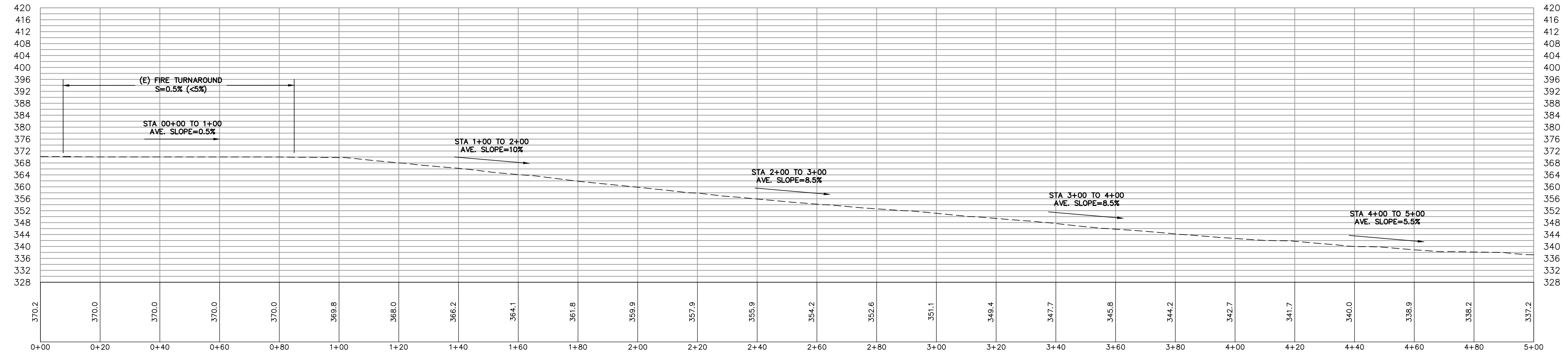

DRIVEWAY PROFILE (STA 0+00 TO 5+00)  
SCALE: 1"=20' HORIZONTAL, VERTICAL

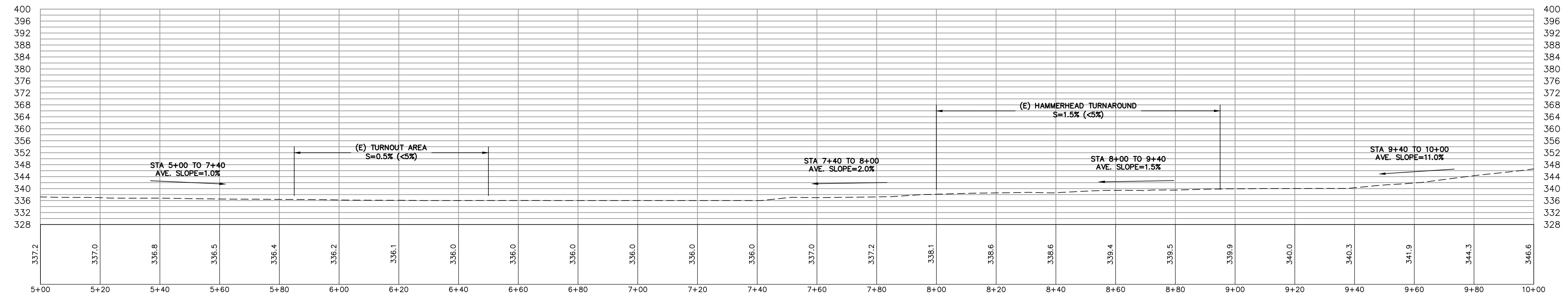

DRIVEWAY PROFILE (STA 5+00 TO 10+00)  
SCALE: 1"=20' HORIZONTAL, VERTICAL

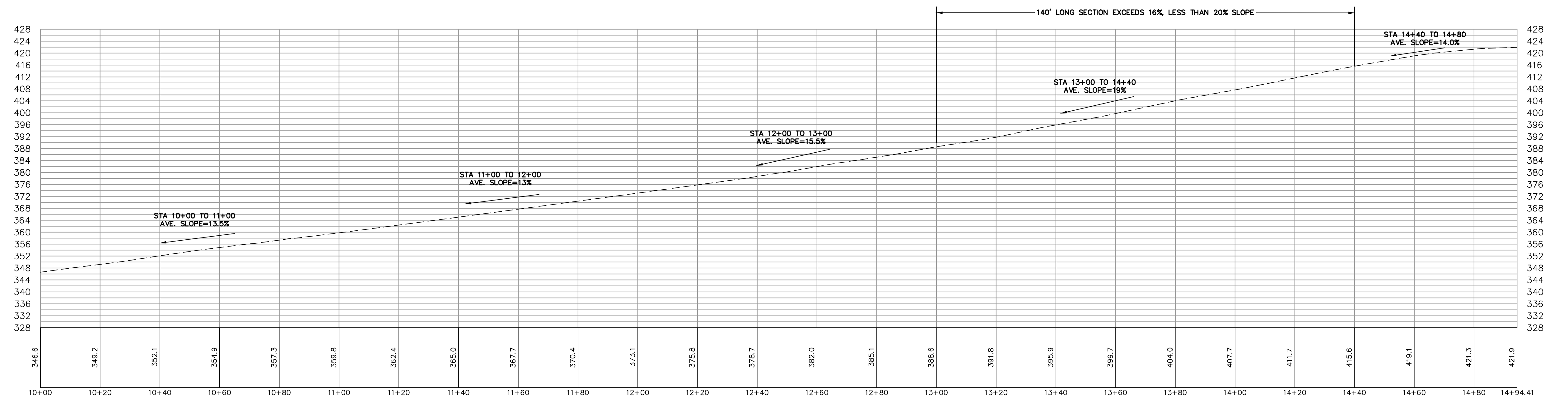

DRIVEWAY PROFILE (STA 10+00 TO 14+94)  
SCALE: 1"=20' HORIZONTAL, VERTICAL

NOTE: ENTIRE DRIVEWAY SLOPE LESS THAN 16%, EXCEPT FOR 160' LONG SECTION AT STATION 13+00 TO 14+40  
DRIVEWAY TO BE PAVED UNDER PERMIT No. 6201485



3/8/2024



RI Engineering, Inc.

303 Potrero St., Suite 42-202, Santa Cruz, CA 95060  
831-425-9901 www.riengineering.com

SINGLE FAMILY RESIDENCE  
FOR  
SAL AKHTER  
2580 BRIDLE PATH DR  
GILROY, CALIFORNIA  
APN: 830-17-059

DRIVEWAY PROFILE  
project no. 14-067-2  
date MARCH 2024  
scale AS SHOWN  
dwg name CIVIL-STREAM.DWG

C-4



TOTAL AREA OF DISTURBANCE = 40,660 SQFT

**ABBREVIATIONS**

C	CENTERLINE
DTL	DETAIL
DWY	DRIVEWAY
(E)	EXISTING
EL	ELEVATION
NTS	NOT TO SCALE
S	SLOPE
SCCO	SANTA CLARA COUNTY
STA	STATION
TYP	TYPICAL

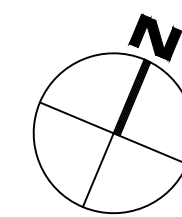

**EROSION CONTROL LEGEND**

- INSTALL FIBER ROLL PER DETAILS THIS SHEET
- INSTALL CATCH BASIN PROTECTION PER DETAIL THIS SHEET
- PROPOSED SLOPE PROTECTION
- PROPOSED STAGING AREA
- PROPOSED STOCKPILE AREA
- PROPOSED ROCK CHECK DAM

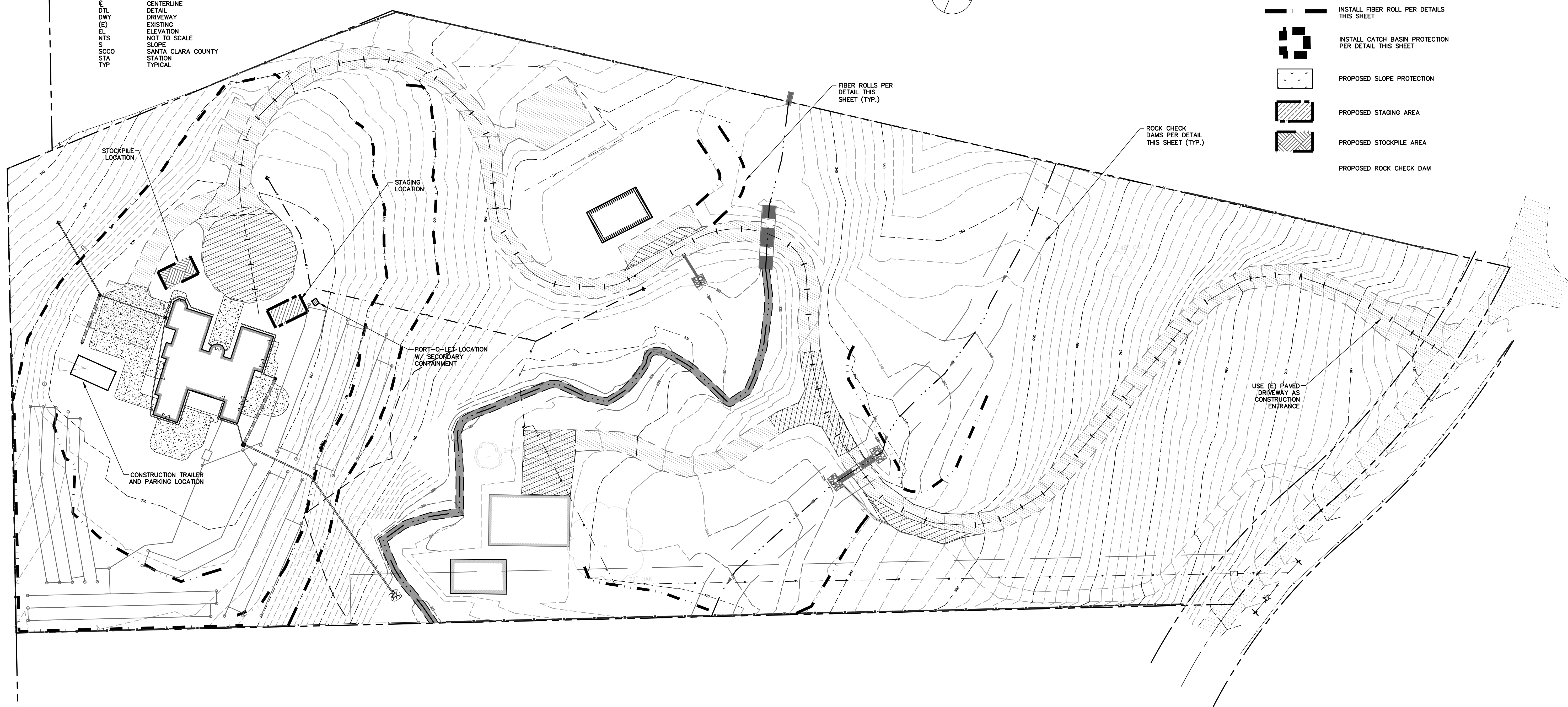

USE (E) PAVED DRIVEWAY AS CONSTRUCTION ENTRANCE

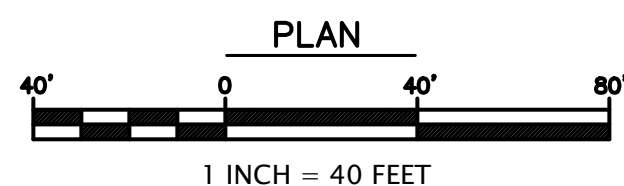

**PLAN**

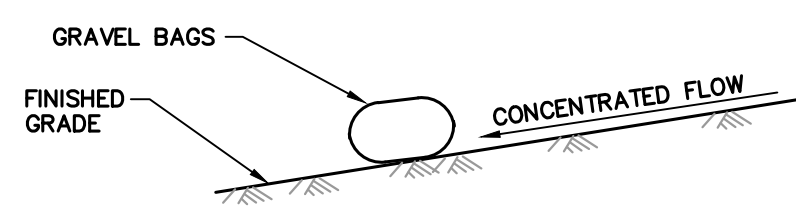

**SECTION**

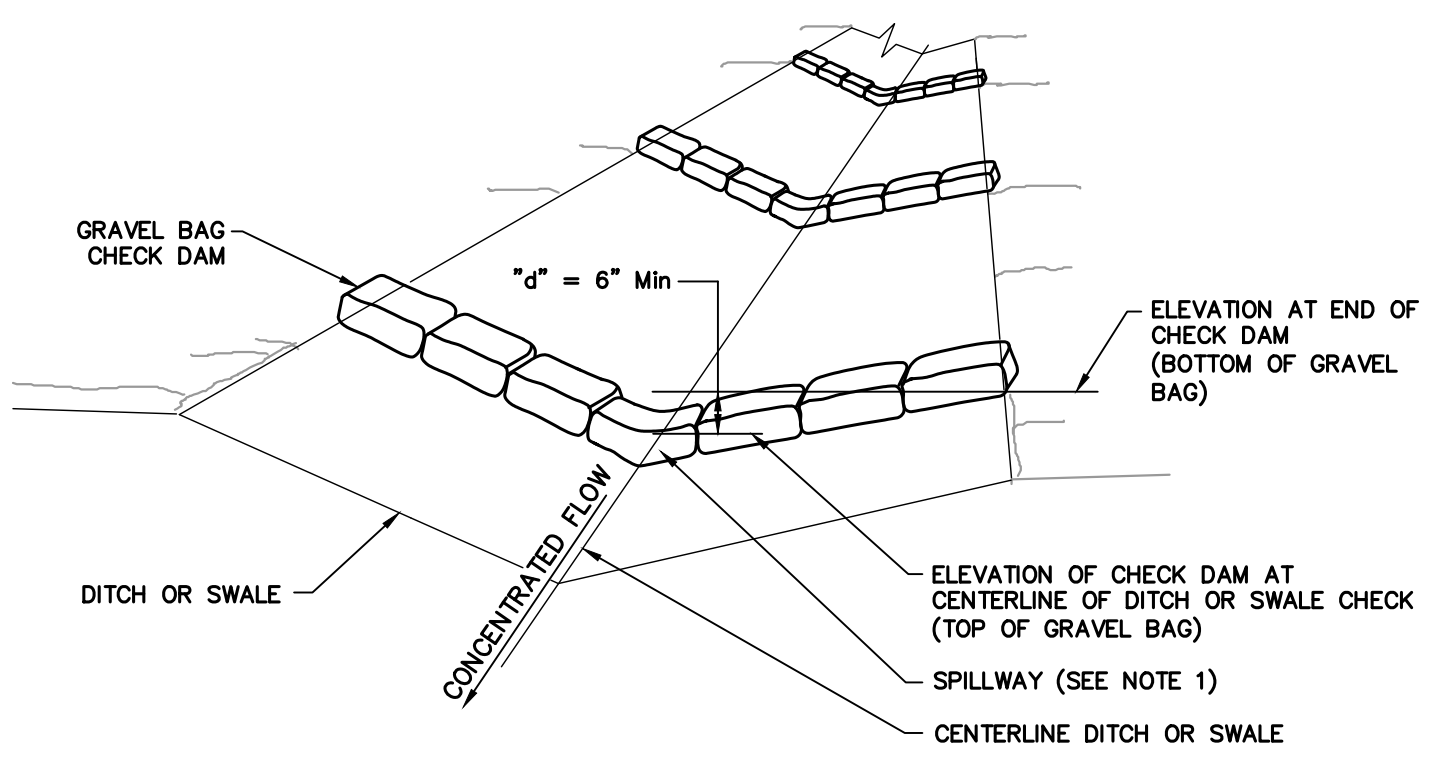

**GRAVEL BAG CHECK DAM**

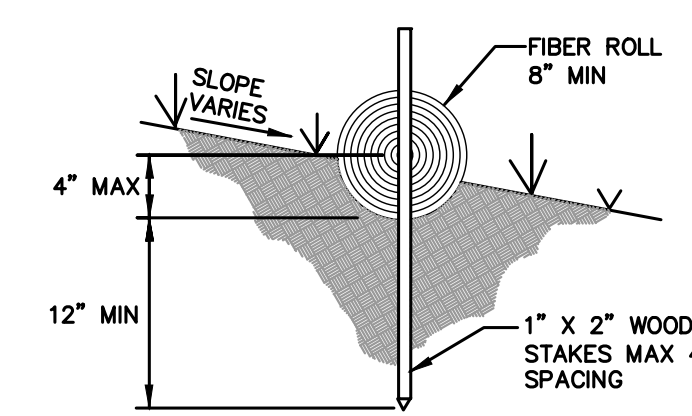

**FIBER ROLL DETAIL IN SLOPE AREA**

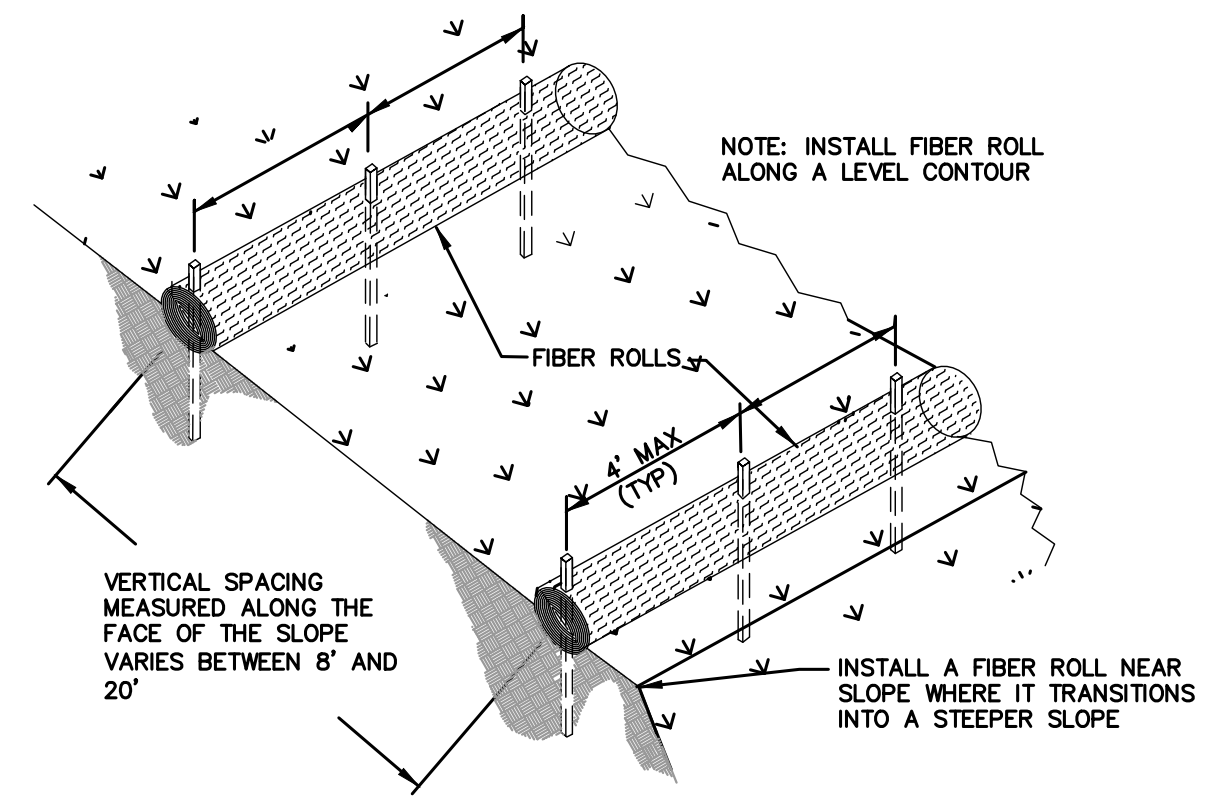

**TYPICAL FIBER ROLL INSTALLATION**

**EROSION CONTROL MEASURES**

- EROSION IS TO BE CONTROLLED AT ALL TIMES ALTHOUGH SPECIFIC MEASURES SHOWN. DURING THE PERIOD OF OCTOBER 15TH TO APRIL 15TH, SHOWN MEASURES SHALL BE INSTALLED BY THE TIME OF THE INITIAL "GRADE STAKE" INSPECTION. THERE SHALL BE NO CONSTRUCTION INVOLVING THE REBUILDING AND RE-ALIGNMENT OF WATERWAYS DURING THE RAINY SEASON AND/OR FORECASTED RAIN EVENTS.
- ALL FILL SLOPES SHALL BE COMPACTED AND LEFT IN A SMOOTH FIRM CONDITION CAPABLE OF WITHSTANDING WEATHERING.
- ALL DITCHES SHALL BE LINED WITH GRASS OR 4" HAND PLACED COBBLE
- ALL EXPOSED DISTURBED AREAS SHALL BE SEEDED AT A RATE OF 5# BROME SEED PER 1000 SF SEEDING AND WATERING SHALL BE MAINTAINED TO ENSURE GROWTH.
- ALL STORM DRAINAGE STRUCTURES SHALL BE INSTALLED WITH EFFECTIVE ENTRANCE AND OUTFALL EROSION CONTROLS, E.G. SACKED CONCRETE RIP-RAP. ENERGY DISSIPATORS SHALL BE INSTALLED AT ALL DITCH OUTFALLS. WHERE OUTFALLS ARE NOT INTO AN EXISTING CREEK OR WATER COURSE RUNOFF SHALL BE RELEASED TO SHEET FLOW
- PLANTING SHALL BE COMPLETED NOT MORE THAN 90 DAYS AFTER COMPLETION OF GRADING
- THE DESIRED END RESULT OF THESE MEASURES IS TO CONTROL SITE EROSION AND PREVENT SEDIMENT TRANSPORT OFF THE SITE. IT SHALL BE THE DEVELOPER'S RESPONSIBILITY TO SEE THAT ANY ADDITIONAL MEASURES NECESSARY TO MEET THIS GOAL ARE IMPLEMENTED. IF FAILED INSPECTIONS BY COUNTY STAFF SHOW THIS GOAL IS NOT BEING MET, ADDITIONAL MEASURES MAY BE REQUIRED.
- GRADING WORK BETWEEN OCTOBER 15 AND APRIL 15 IS AT THE DISCRETION OF THE SANTA CLARA COUNTY BUILDING OFFICIAL.
- IN ADDITION TO NOTE 4 ABOVE, SLOPES GREATER THAN 15' VERTICAL HEIGHT SHALL BE PLANTED WITH SHRUBS IN 2" POTS OR LARGER, SPACED AT INTERVALS OF 10' OR LESS ON CENTERS, OR TREES HAVING A ONE GALLON MINIMUM SIZE AT 20' INTERVALS, OR A COMBINATION OF TREES AND SHRUBS AT A SPACING APPROPRIATE TO THE SPECIES. THE PLANS SELECTED AND THE PLANTING METHODS USED SHALL BE SUITABLE FOR THE SOIL AND CLIMATE CONDITIONS OF THE SITE.

**EXPOSED SLOPE MEASURES**

- COVER ALL EXPOSED SLOPES
- STRAW 2 TONS/ACRE ON SLOPES ≤ 20% WITH SOIL BINDER
- USE NORTH AMERICAN GREEN C125 OR EQUAL ON SLOPES >20%



**RI Engineering, Inc.**  
 303 Potrero St., Suite 42-202, Santa Cruz, CA 95060  
 831-425-9901 www.riengineering.com

SINGLE FAMILY RESIDENCE  
 FOR  
 SAL AKHTER  
 2580 BRIDLE PATH DR  
 GILROY, CALIFORNIA  
 APN: 830-17-059  
**EROSION CONTROL PLAN**

project no.  
 14-067-2  
 date  
 MARCH 2024  
 scale  
 AS SHOWN  
 dwg name  
 CIVIL-STREAM.DWG

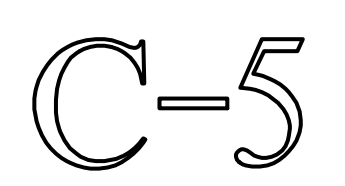



### 3 Stabilized Construction Entrance/Exit

CASQA Detail TC-1

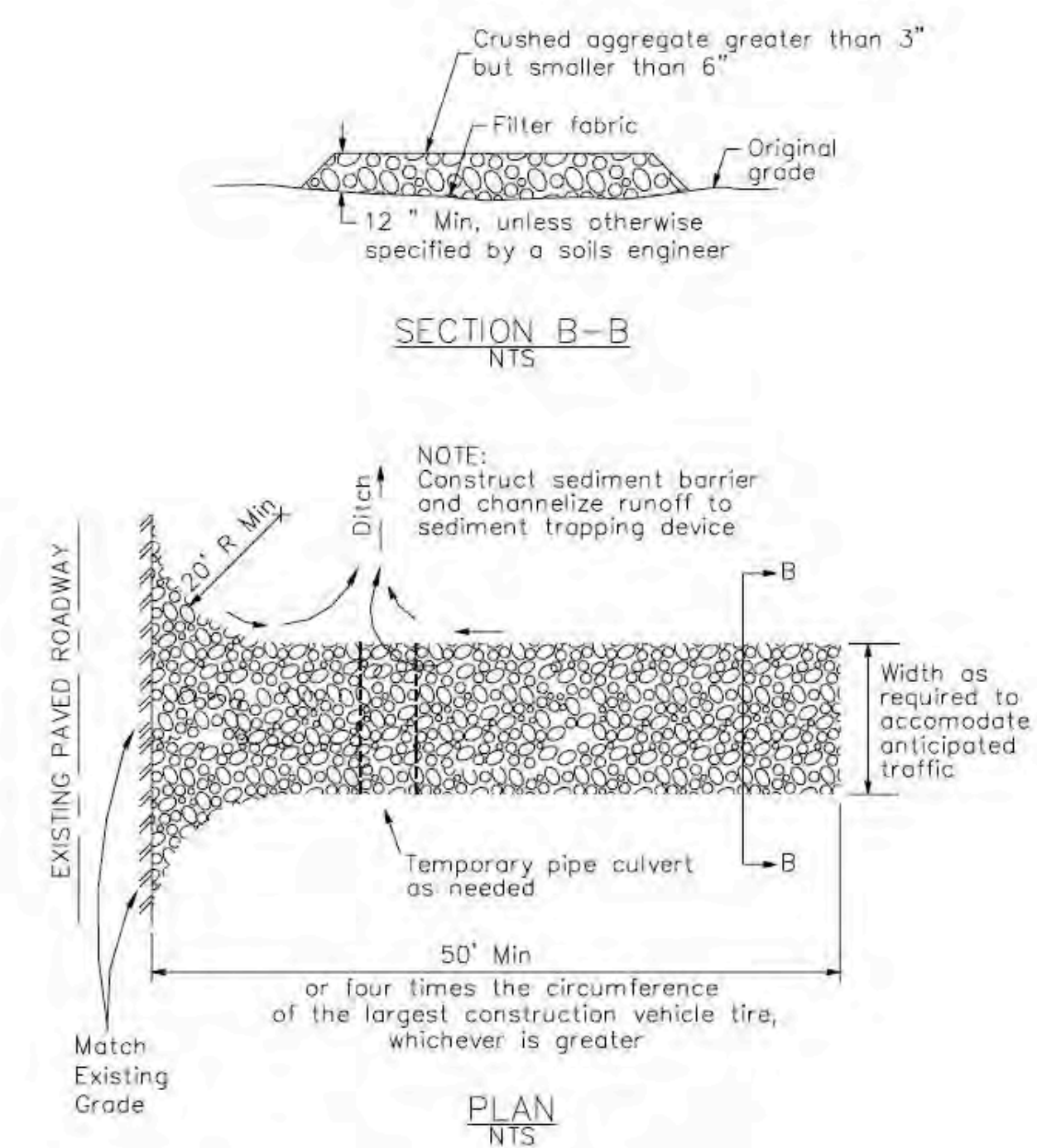

### 4 Velocity Dissipation Devices

CASQA Detail EC-10

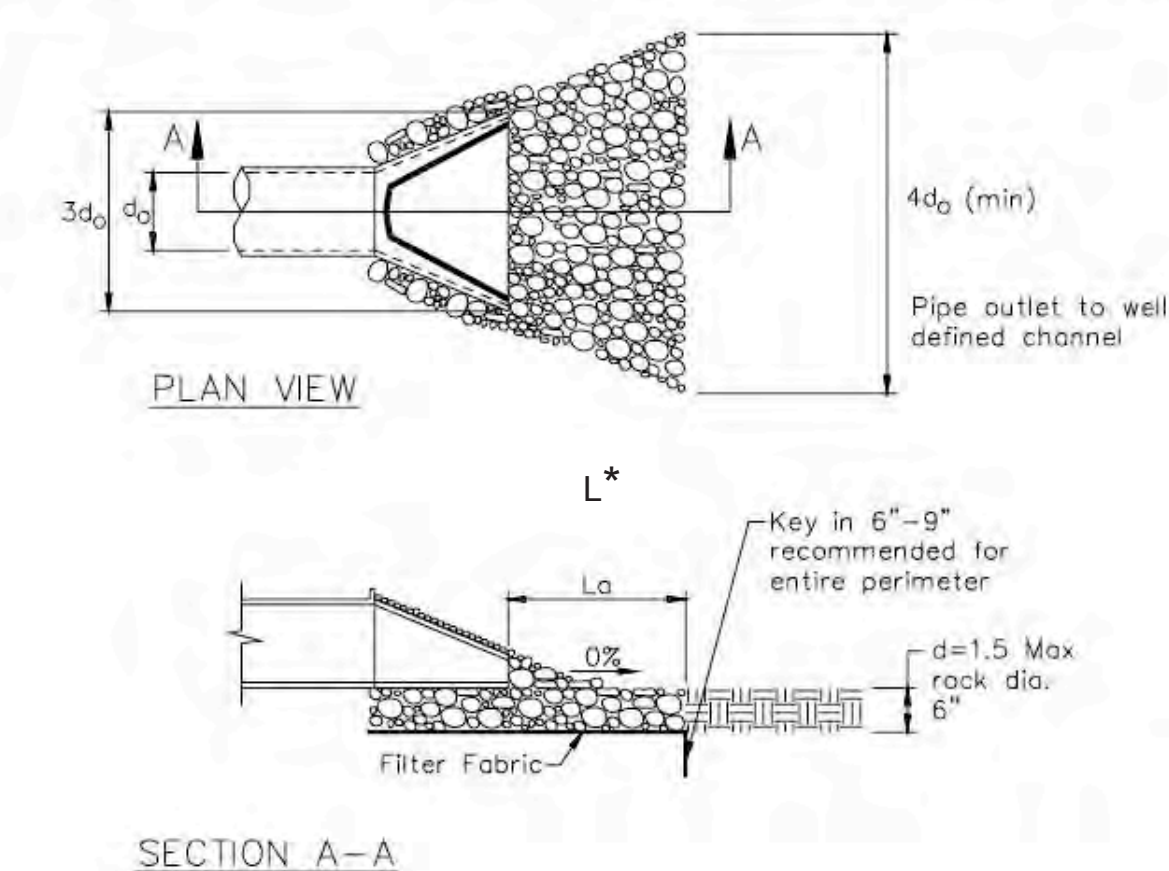

\* Length per ABAG Design Standards

Source for Graphics: California Stormwater BMP Handbook, California Stormwater Quality Association, January 2003. Available from www.cabmphandbooks.com.

### 1 Silt Fence

CASQA Detail SE-1

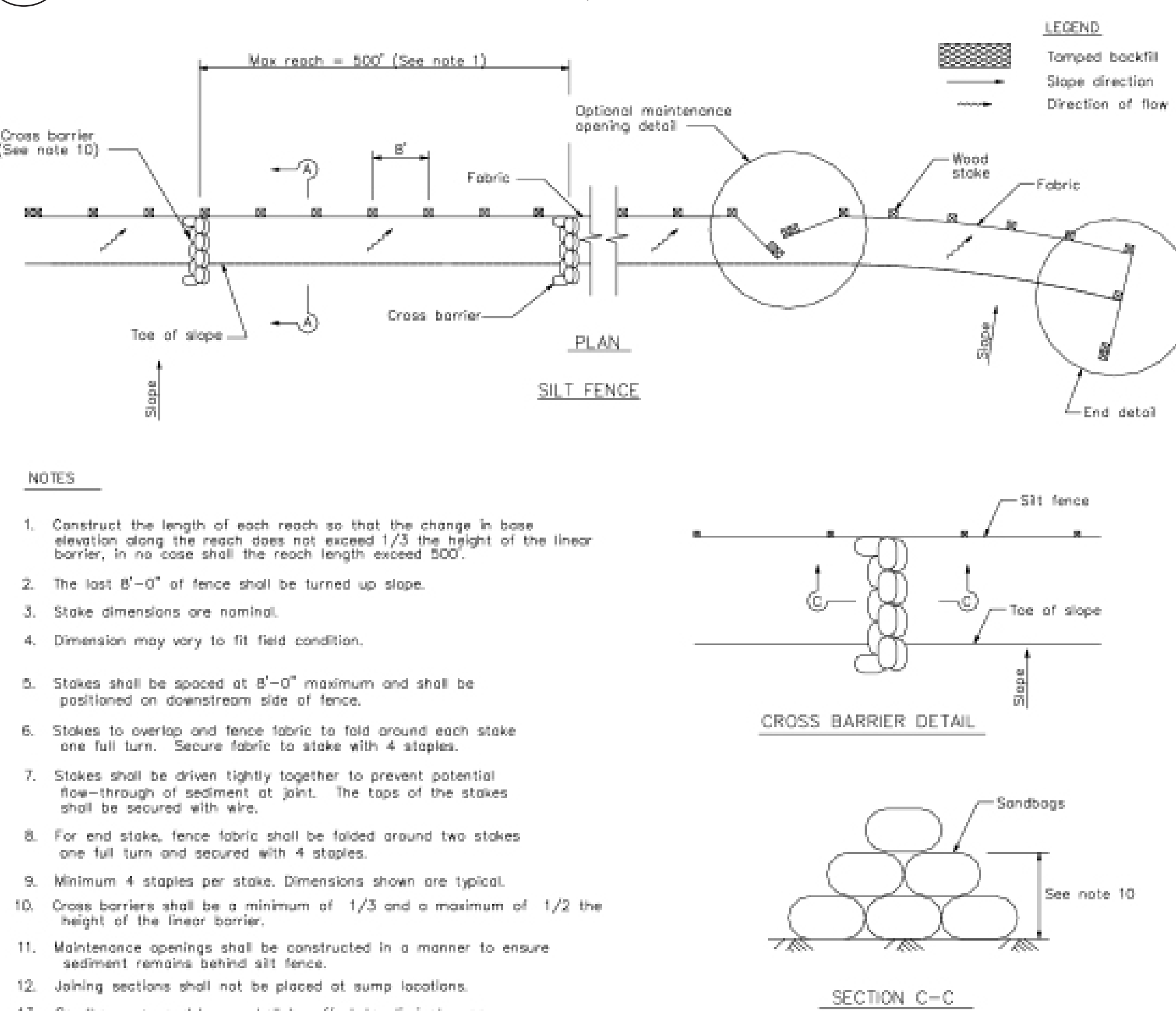

### 2 Silt Fence

CASQA Detail SE-1

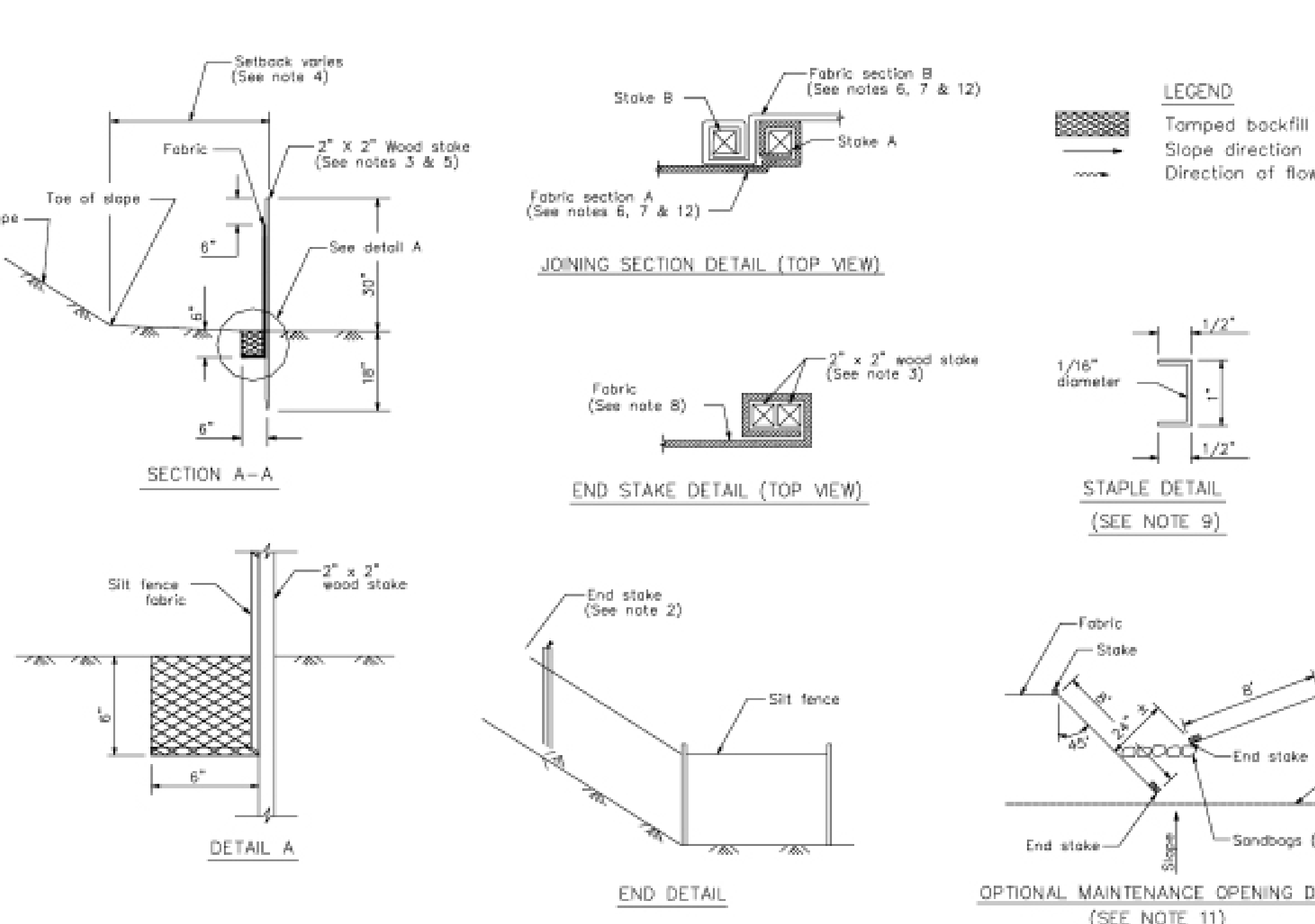

### STANDARD BEST MANAGEMENT PRACTICE NOTES

- Solid and Demolition Waste Management:** Provide designated waste collection areas and containers on site away from streets, gutters, storm drains, and waterways, and arrange for regular disposal. Waste containers must be watertight and covered at all times except when waste is deposited. Refer to Erosion & Sediment Control Field Manual, 4th Edition (page C3) or latest.
- Hazardous Waste Management:** Provide proper handling and disposal of hazardous wastes by a licensed hazardous waste material hauler. Hazardous wastes shall be stored and properly labeled in sealed containers constructed of suitable materials. Refer to Erosion & Sediment Control Field Manual, 4th Edition (pages C-5 to C-6) or latest.
- Spill Prevention and Control:** Provide proper storage areas for liquid and solid materials, including chemicals and hazardous substances, away from streets, gutters, storm drains, and waterways. Spill control materials must be kept on site where readily accessible. Spills must be cleaned up immediately and contaminated soil disposed properly. Refer to Erosion & Sediment Control Field Manual, 4th Edition (pages C-7 to C-8, C-13 to C-14) or latest.
- Vehicle and Construction Equipment Service and Storage:** An area shall be designated for the maintenance, where on-site maintenance is required, and storage of equipment that is protected from stormwater run-on and runoff. Measures shall be provided to capture any waste oils, lubricants, or other potential pollutants and these wastes shall be properly disposed of off site. Fueling and major maintenance/repair, and washing shall be conducted off-site whenever feasible. Refer to Erosion & Sediment Control Field Manual, 4th Edition (page C9) or latest.
- Material Delivery, Handling and Storage:** In general, materials should not be stockpiled on site. Where temporary stockpiles are necessary and approved by the County, they shall be covered with secured plastic sheeting or tarp and located in designated areas near construction entrances and away from drainage paths and waterways. Barriers shall be provided around storage areas where materials are potentially in contact with runoff. Refer to Erosion & Sediment Control Field Manual, 4th Edition (pages C-11 to C-12) or latest.
- Handling and Disposal of Concrete and Cement:** When concrete trucks and equipment are washed on-site, concrete wastewater shall be contained in designated containers or in a temporary lined and watertight pit where wasted concrete can harden for later removal. If possible have concrete contractor remove concrete wash water from site. In no case shall fresh concrete be washed into the road right-of-way. Refer to Erosion & Sediment Control Field Manual, 4th Edition (pages C-15 to C-16) or latest.
- Pavement Construction Management:** Prevent or reduce the discharge of pollutants from paving operations, using measures to prevent run-on and runoff pollution and properly disposing of wastes. Avoid paving in the wet season and reschedule paving when rain is in the forecast. Residue from saw-cutting shall be vacuumed for proper disposal. Refer to Erosion & Sediment Control Field Manual, 4th Edition (pages C-17 to C-18) or latest.
- Contaminated Soil and Water Management:** Inspections to identify contaminated soils should occur prior to construction and at regular intervals during construction. Remediating contaminated soil should occur promptly after identification and be specific to the contaminant identified, which may include hazardous waste removal. Refer to Erosion & Sediment Control Field Manual, 4th Edition (pages C-19 to C-20) or latest.
- Sanitary/Septic Water Management:** Temporary sanitary facilities should be located away from drainage paths, waterways, and traffic areas. Only licensed sanitary and septic waste haulers should be used. Secondary containment should be provided for all sanitary facilities. Refer to Erosion & Sediment Control Field Manual, 4th Edition (page C-21) or latest.
- Inspection & Maintenance:** Areas of material and equipment storage sites and temporary sanitary facilities must be inspected weekly. Problem areas shall be identified and appropriate additional and/or alternative control measures implemented immediately, within 24 hours of the problem being identified.

### STANDARD EROSION CONTROL NOTES

- Sediment Control Management:**
  - Tracking Prevention & Clean Up:** Activities shall be organized and measures taken as needed to prevent or minimize tracking of soil onto the public street system. A gravel or proprietary device construction entrance/exit is required for all sites. Clean up of tracked material shall be provided by means of a street sweeper prior to an approaching rain event, or at least once at the end of each workday that material is tracked, or, more frequently as determined by the County Inspector. Refer to Erosion & Sediment Control Field Manual, 4th Edition (pages B-31 to B-33) or latest.
  - Storm Drain Inlet and Catch Basin Inlet Protection:** All inlets within the vicinity of the project and within the project limits shall be protected with gravel bags placed around inlets or other inlet protection. At locations where exposed soils are present, staked fiber rolls or staked silt fences can be used. Inlet filters are not allowed due to clogging and subsequent flooding. Refer to Erosion & Sediment Control Field Manual, 4th Edition (pages B-49 to B-51) or latest.
  - Storm Water Runoff:** No storm water runoff shall be allowed to drain in to the existing and/or proposed underground storm drain system or other above ground watercourses until appropriate erosion control measures are fully installed.
  - Dust Control:** The contractor shall provide dust control in graded areas as required by providing wet suppression or chemical stabilization of exposed soils, providing for rapid clean up of sediments deposited on paved roads, furnishing construction road entrances and vehicle wash down areas, and limiting the amount of areas disturbed by clearing and earth moving operations by scheduling these activities in phases.
  - Stockpiling:** Excavated soils shall not be placed in streets or on paved areas. Borrow and temporary stockpiles shall be protected with appropriate erosion control measures (tarps, straw bales, silt fences, etc.) to ensure silt does not leave the site or enter the storm drain system or neighboring watercourse.
- Erosion Control:** During the rainy season, all disturbed areas must include an effective combination of erosion and sediment control. It is required that temporary erosion control measures are applied to all disturbed soil areas prior to a rain event. During the non-rainy season, erosion control measures must be applied sufficient to control wind erosion at the site.
- Inspection & Maintenance:** Disturbed areas of the Project's site, locations where vehicles enter or exit the site, and all erosion and sediment controls that are identified as part of the Erosion Control Plans must be inspected by the Contractor before, during, and after storm events, and at least weekly during seasonal wet periods. Problem areas shall be identified and appropriate additional and/or alternative control measures implemented immediately, within 24 hours of the problem being identified.
- Project Completion:** Prior to project completion and signoff by the County Inspector, all disturbed areas shall be reseeded, planted, or landscaped to minimize the potential for erosion on the subject site.
- It shall be the Owner's/Contractor's responsibility to maintain control of the entire construction operation and to keep the entire site in compliance with the erosion control plan.
- Erosion and sediment control best management practices shall be operable year round or until vegetation is fully established on landscaped surfaces.

## Project Information

STREAM GRADING ABATEMENT  
FOR  
SAL AKHTER  
2580 BRIDLE PATH DR  
COUNTY FILE NO. 8208-18GA

APPLICANT: SAL AKHTER  
ROAD: 2580 BRIDLE PATH DR.  
COUNTY FILE NO. 8208-18GA

BMP-1





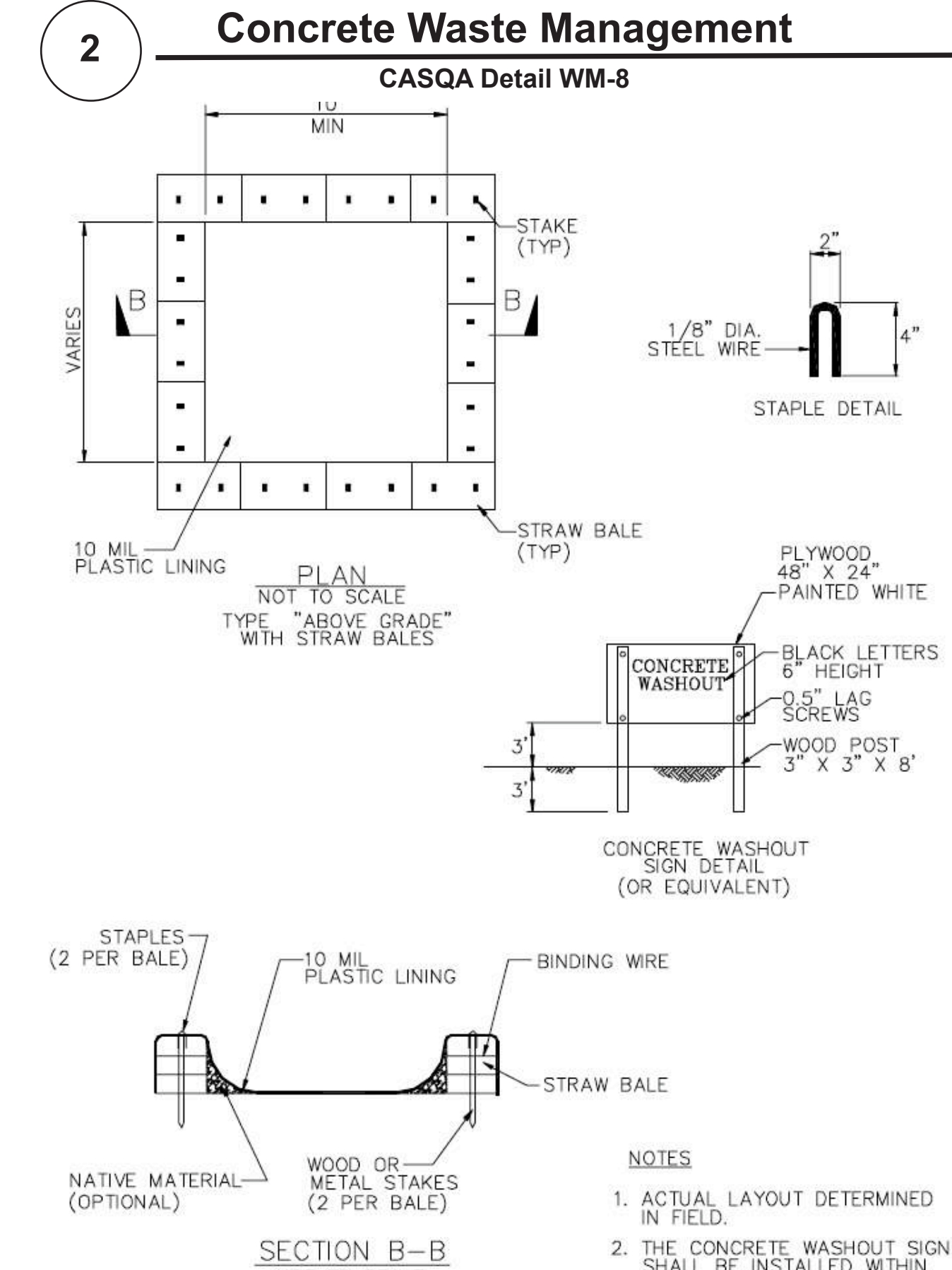
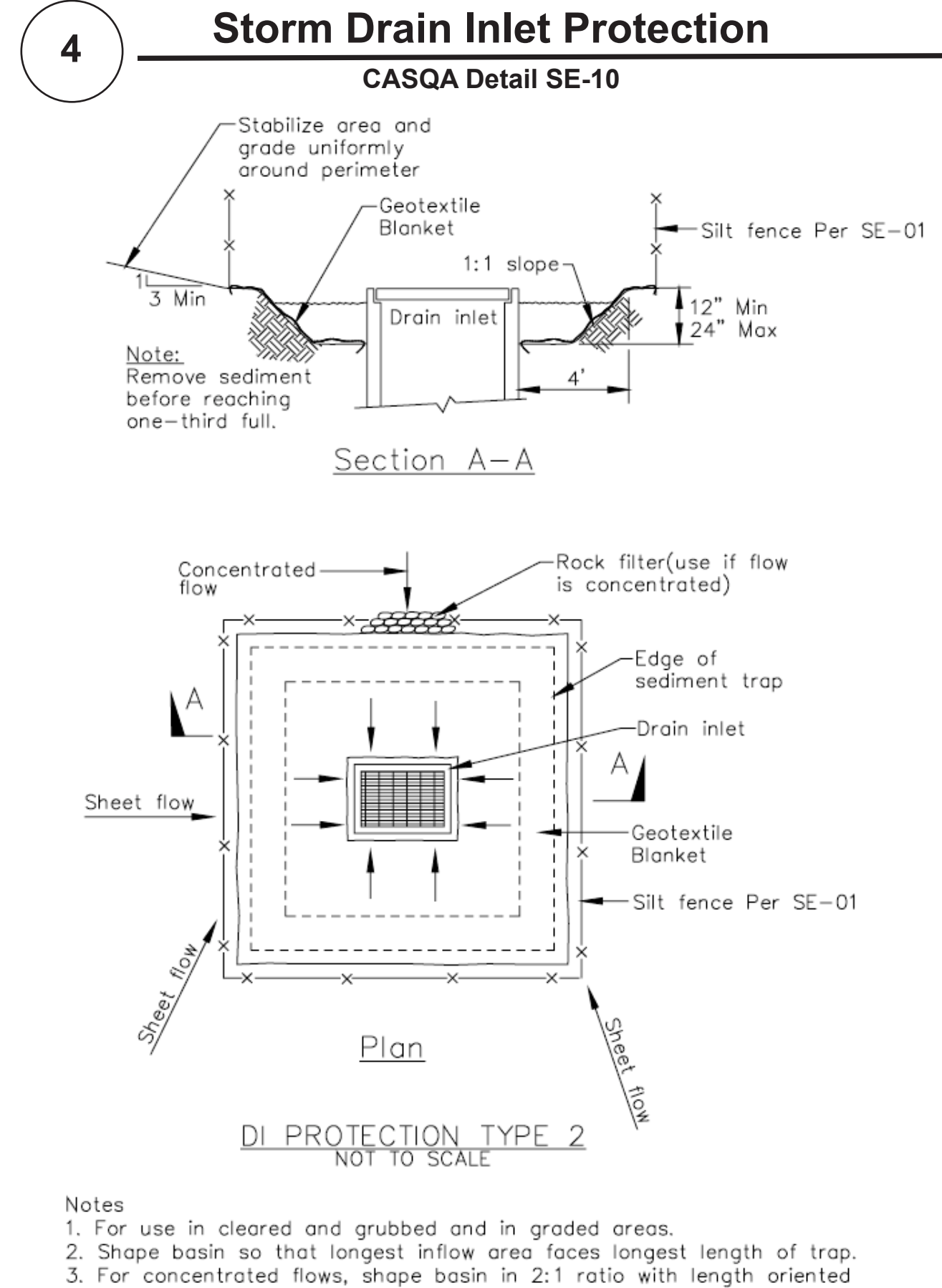
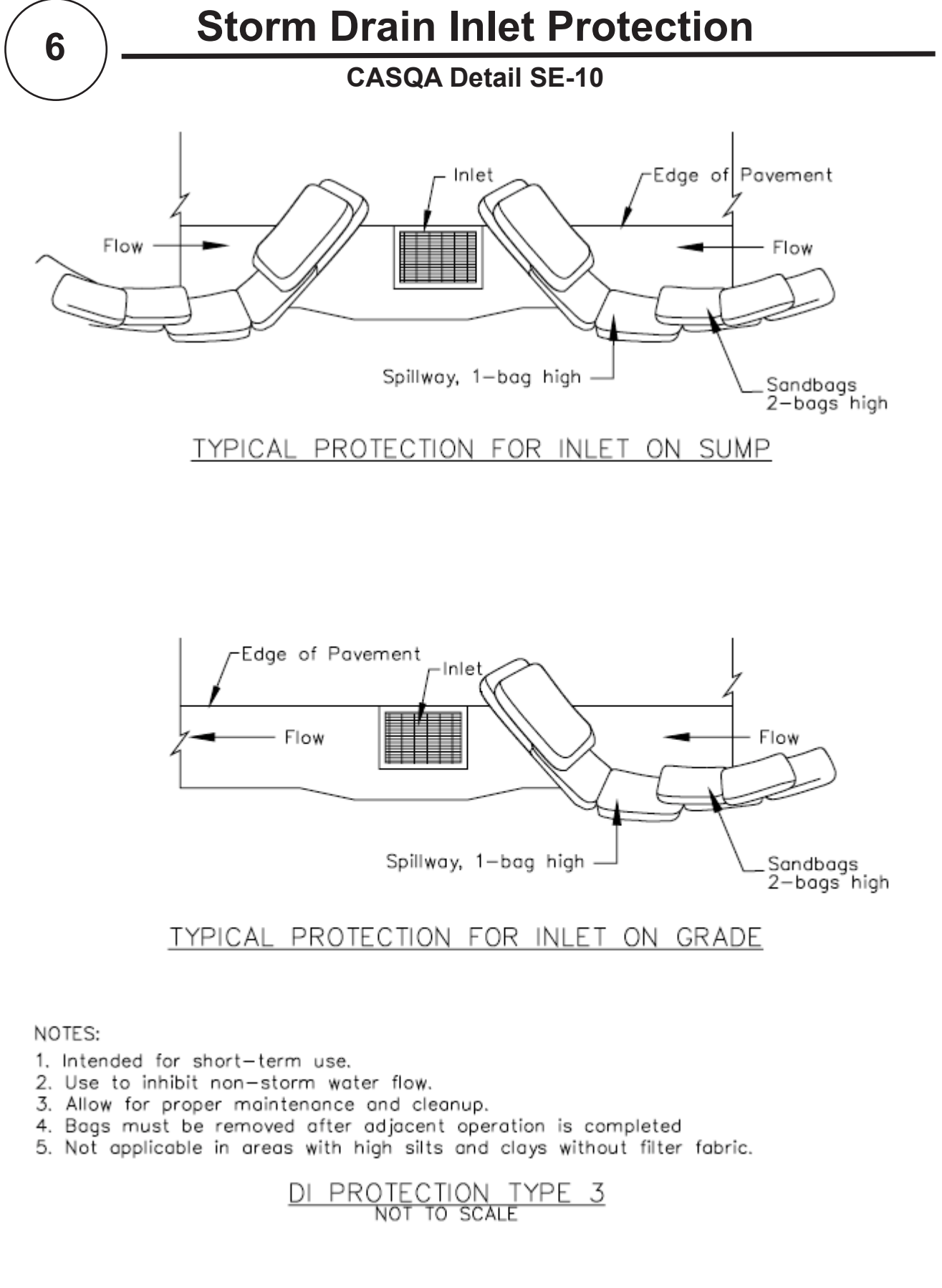
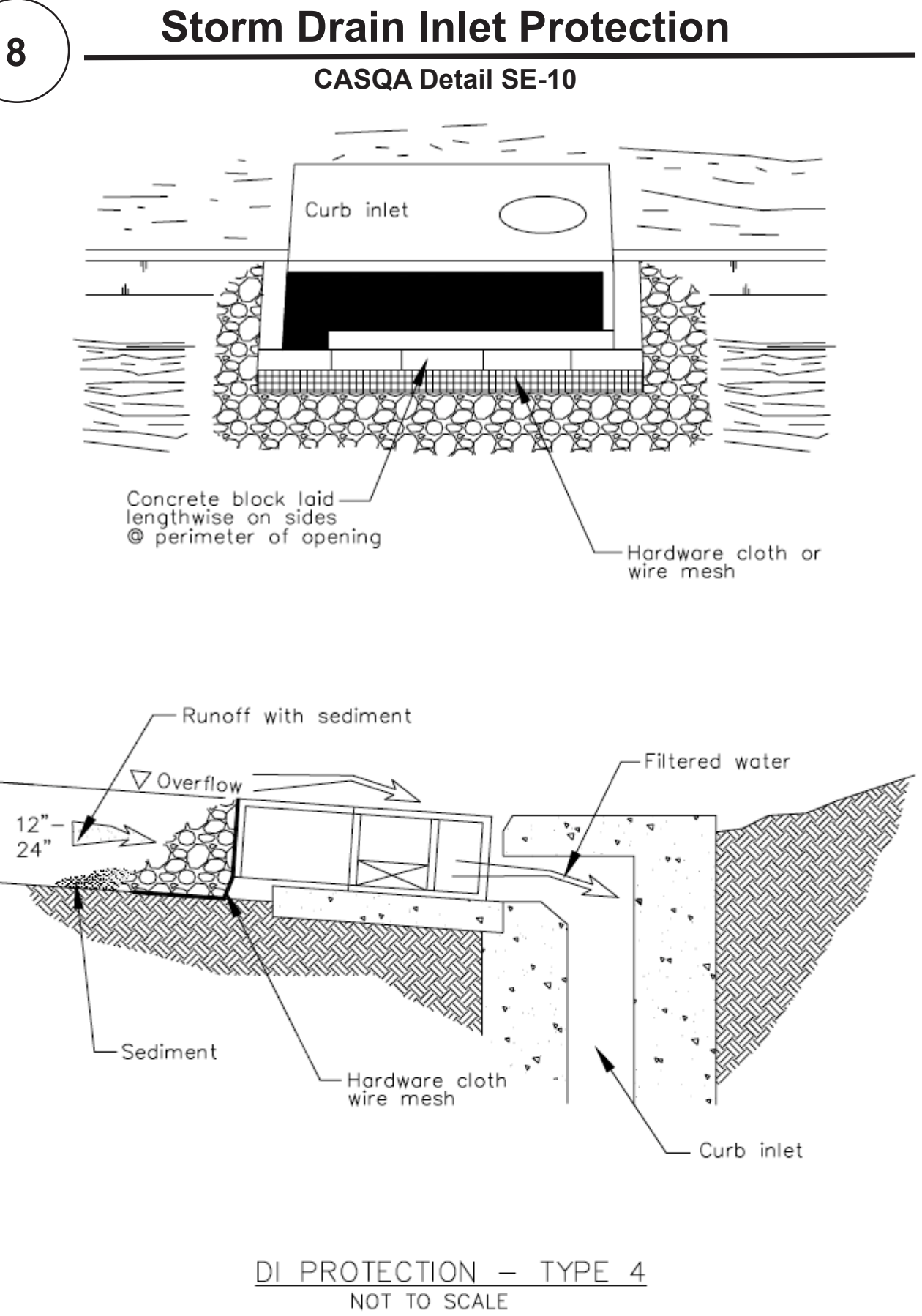
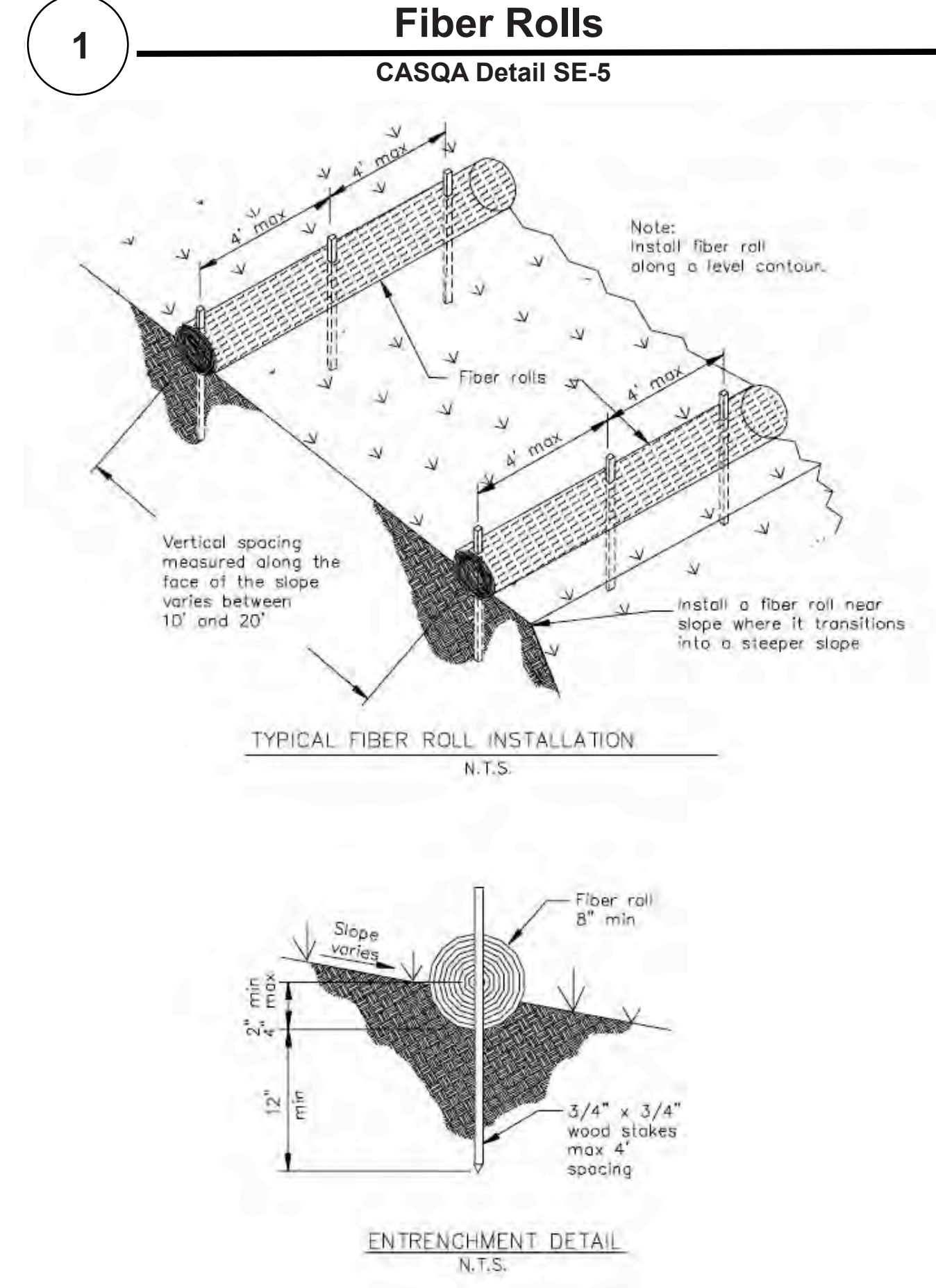
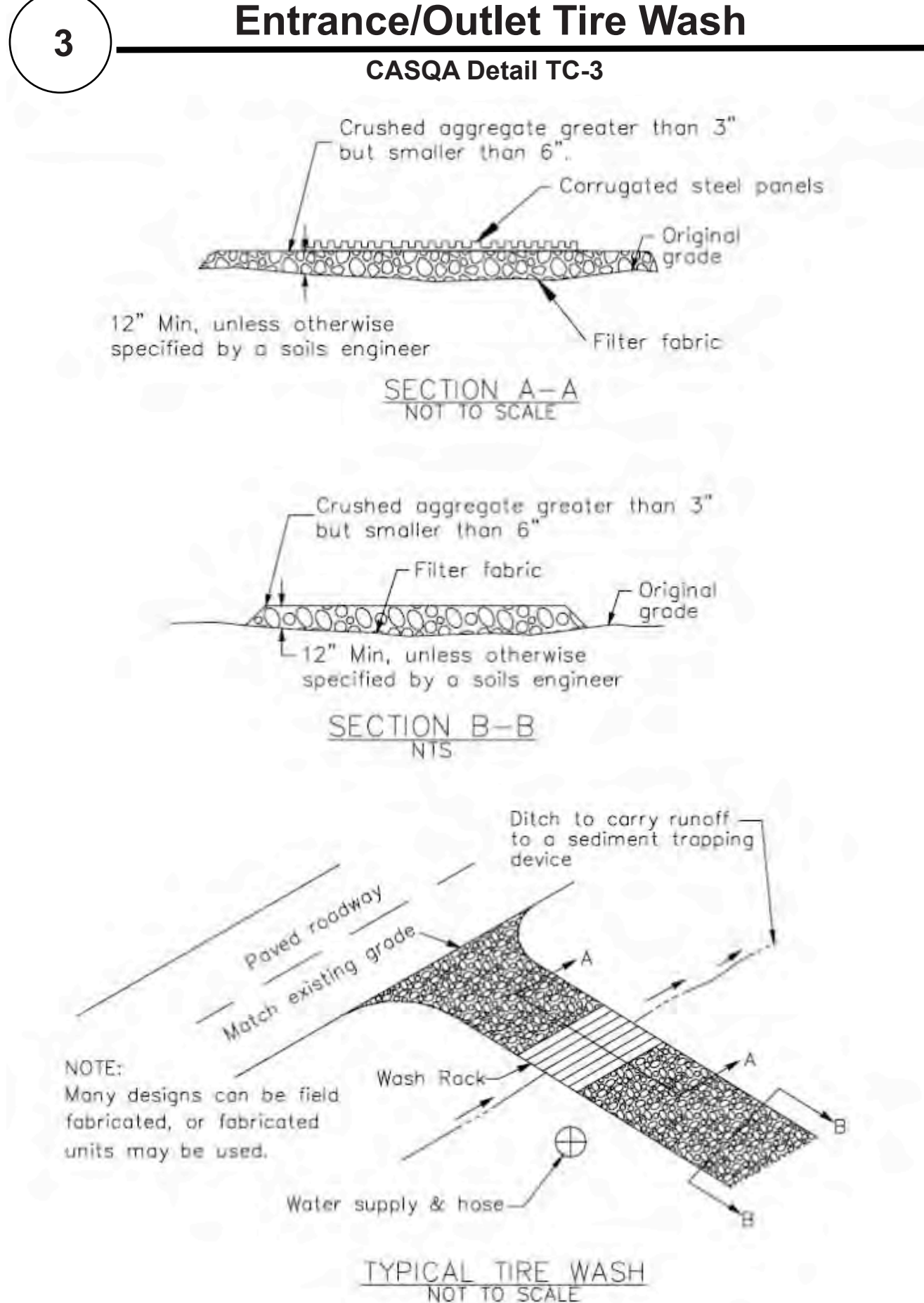
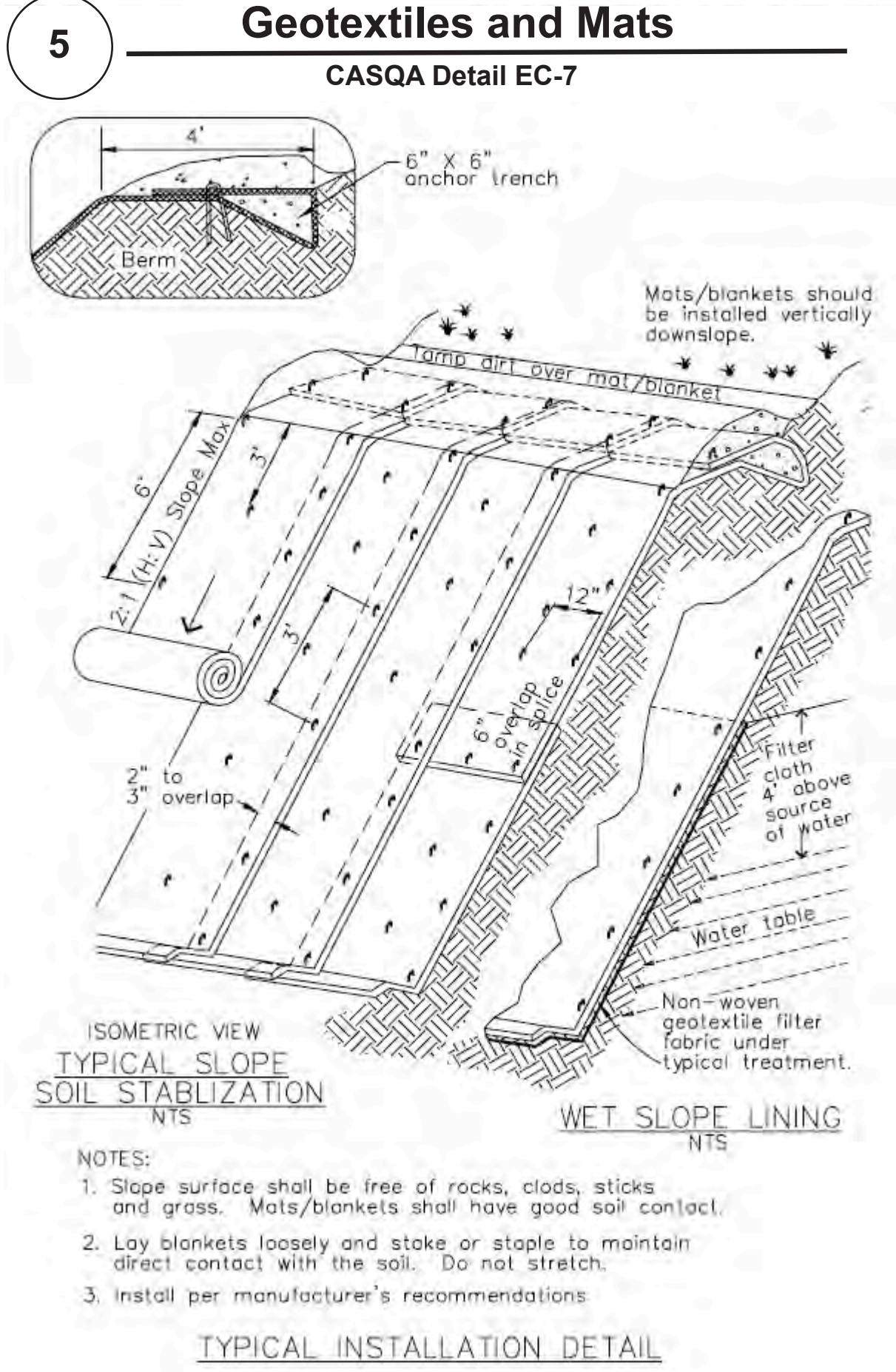
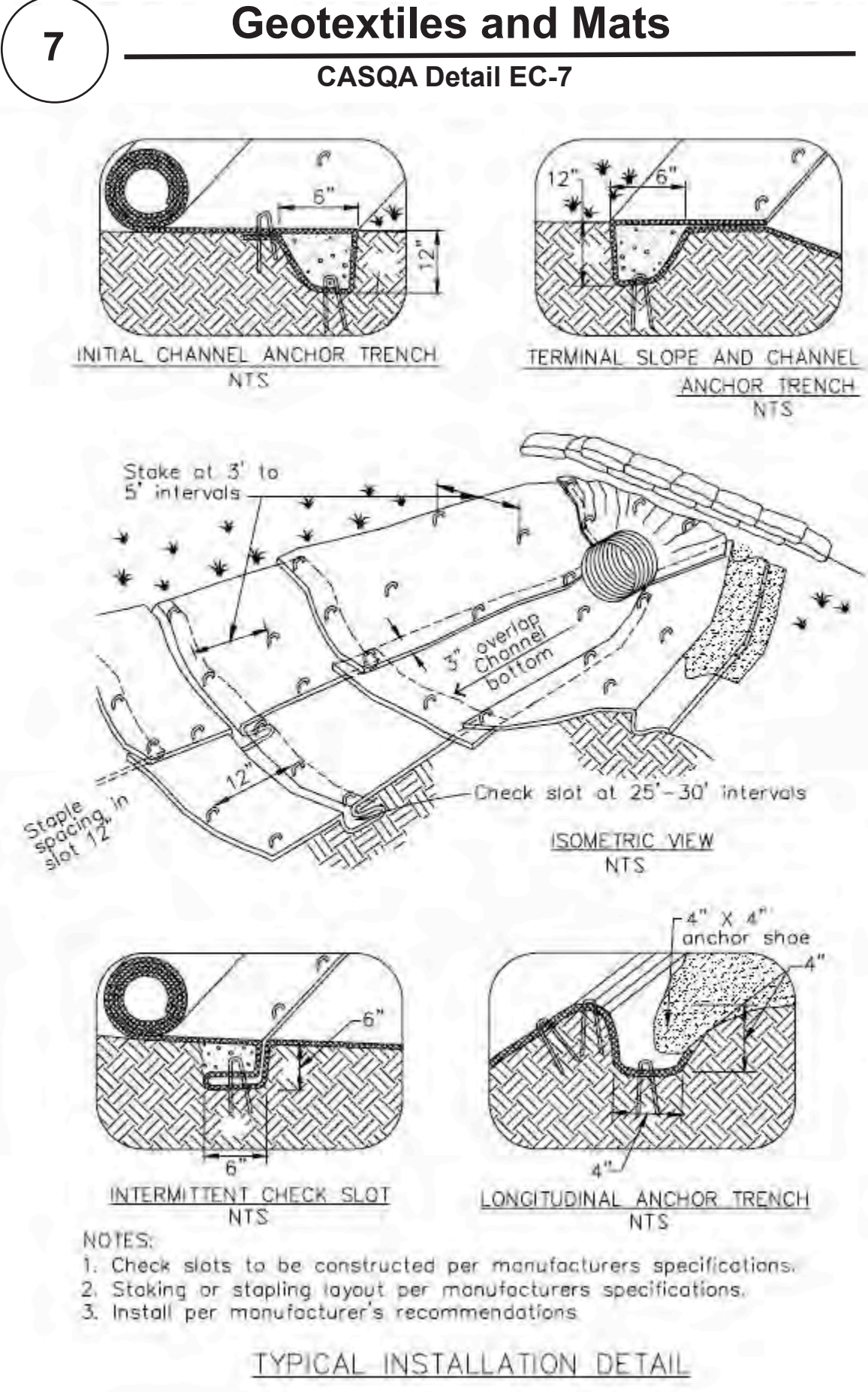

Source for Graphics: California Stormwater BMP Handbook, California Stormwater Quality Association, January 2003. Available from www.cabmphandbooks.com.

## Project Information

APPLICANT: SAL AKHTER  
ROAD: 2580 BRIDLE PATH DR.  
COUNTY FILE NO. 8208-18GA

STREAM GRADING ABATEMENT  
FOR  
SAL AKHTER  
2580 BRIDLE PATH DR.  
APN: 830-17-059  
PROJECT #14-067-1

